

52mm Double Grid Receivers

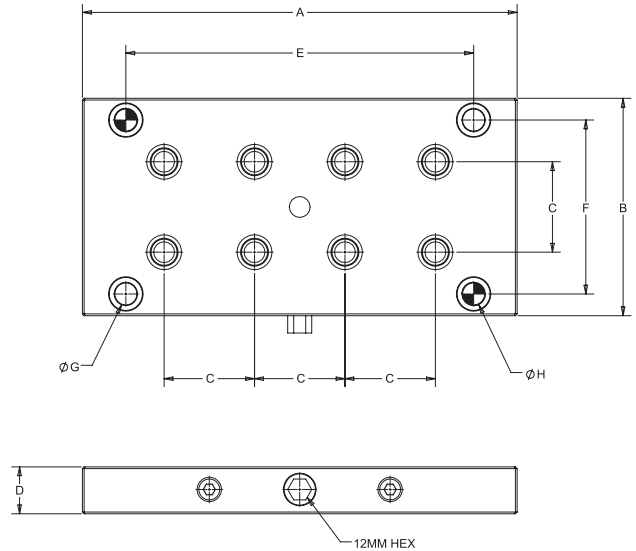

Part Number	A (mm)	B (mm)	C (mm)	D (mm)	Mounting Holes	E (mm)	F (mm)	G (mm)	H (mm)	Weight lbs (kg)	Max. Torque ft*lbs (Nm)	Pull Stud	Fixture-Pro Compatible
QL-100245	250	125	52	27	No	-	-	-	-	12.66 (5.74)	22 (30)	QL-200800	-
QL-100250	250	125	52	27	Yes	200	100	12.7	12H7	12.29 (5.57)	22 (30)	QL-200800	✓ (c)

96mm Double Grid Receivers

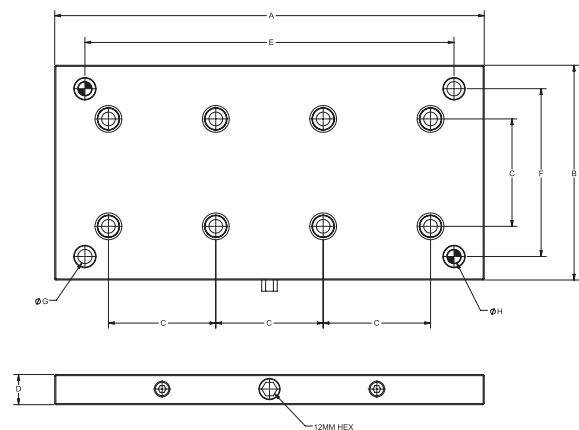

Part Number	A (mm)	B (mm)	C (mm)	D (mm)	Mounting Holes	E (mm)	F (mm)	G (mm)	H (mm)	Weight lbs (kg)	Max. Torque ft*lbs (Nm)	Pull Stud	Fixture-Pro Compatible
QL-100255	384	192	96	27	No	-	-	-	-	31.49 (14.28)	22 (30)	QL-200805	-
QL-100260	384	192	96	27	Yes	350	150	12.7	12H7	30.75 (13.95)	22 (30)	QL-200805	✓

✓ - Receiver will mount to 50mm QLS grid offset from center | ✓ (c) - Receiver will mount to 50mm QLS grid and be centered on grid.