

# TAV40.T

caratteristiche/features

$\varnothing 32$    
 M26   
 2610 N  
 1-2   
 5000 rpm   
  $\pm 0,05$  OUTPUT

peso/weight



70 kg

rotazione/rotation



input



output

prestazioni/performance

Output data

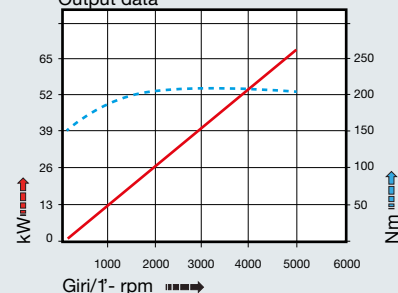

tipi mandrino disponibili / available spindle types

**4** DIN69893-HSK  
HSK63

**5** COROMANT  
CAPTO®  
C5

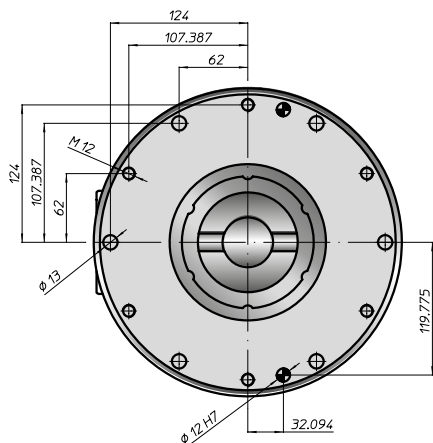
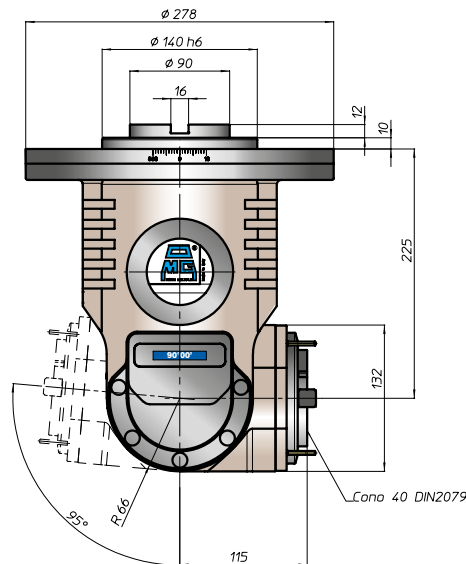
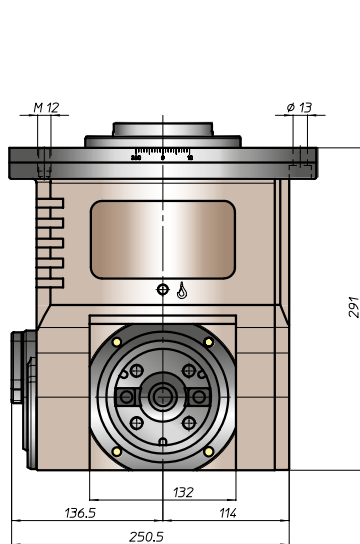

**Equipaggiamento standard:**

- pressurizzazione mandrino
- n. 4 ugelli orientabili vicino al mandrino
- regolazione angolare mandrino libera
- nel mandrino DIN2079 si possono utilizzare coni DIN2080-40, DIN69871-A40, MAS403-BT40

**Standard equipment:**

- spindle front pressurization
- nr 4 adjustable nozzle near the spindle
- free angle spindle adjustment
- on the spindle DIN2079 you can use shank DIN2080-40, DIN69871-A40, MAS403-BT40

esempio di collegamento - *connection example*

