

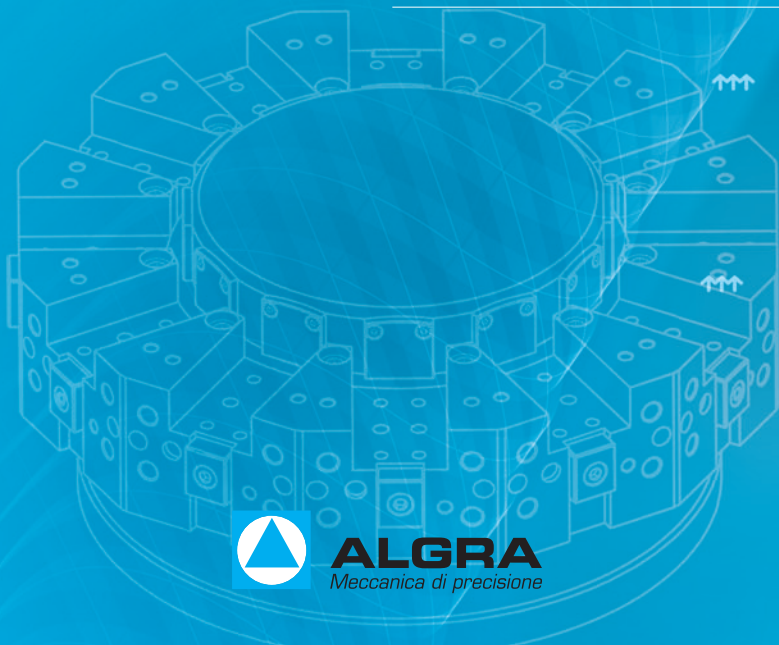

ATTACCO
COUPLING
ACCOUPLEMENT
KUPPLUNG

MO

MO



ALGRA
Meccanica di precisione

ATTACCO

COUPLING - ACCOUPLEMENT - KUPPLUNG

MO

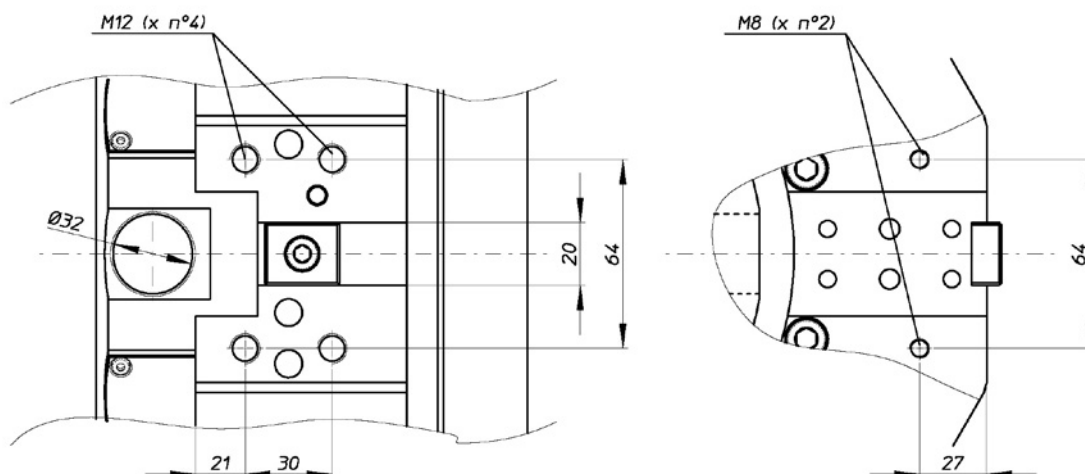
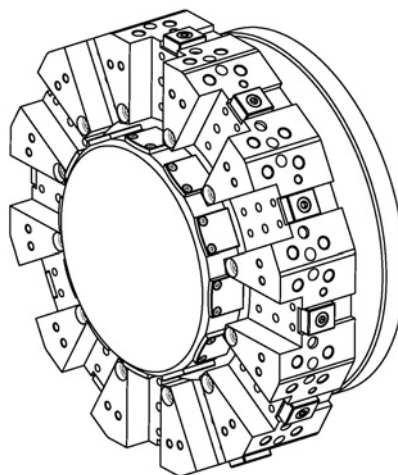

MACCHINE COMPATIBILI

Lathe compatibles - machines compatibles - vereinbarene maschinen

MARCA TORNO	SERIE	MODELLO
Mori-Seiki	SL - ZL	150 - 153 - 154 (MC SMC Y SY)
	DL	DL 150 (MC Y)

PORTAUTENSILI ROTANTI ATTACCO MO

	DISEGNO	CODICE	TIPOLOGIA	TIPO UTENSILE	REFRIGERAZIONE	RAPPORTO TRASMISSIONE	VERSIONE
STANDARD	1/MO 	RAPPS 25 121UM0	ASSIALE	PORTAPINZA ER25	ESTERNA	i=1:1	UNIVERSALE
	2/MO 	RRPPS 25 121DM0	RADIALE	PORTAPINZA ER25	ESTERNA	i=1:1	DRITTO
	3/MO 	RRPPS 25 121RM0	RADIALE	PORTAPINZA ER25	ESTERNA	i=1:1	ROVESCiato
	4/MO 	RRPPT 25 121UM0	RADIALE DOPPIO	PORTAPINZA ER25	ESTERNA	i=1:1	DOPPIO
	5/MO 	ROPPS 20 121UM0	ORIENTABILE	PORTAPINZA ER20	ESTERNA	i=1:1	UNIVERSALE
REFRIGERAZIONE INTERNA-ESTERNA	6/MO 	RAPPS 25 131UM0	ASSIALE	PORTAPINZA ER25	INTERNA-ESTERNA	i=1:1	UNIVERSALE
	7/MO 	RRPPS 25 131DM0	RADIALE	PORTAPINZA ER25	INTERNA-ESTERNA	i=1:1	DRITTO
	8/MO 	RRPPS 25 131RM0	RADIALE	PORTAPINZA ER25	INTERNA-ESTERNA	i=1:1	ROVESCiato
	9/MO 	ROPPS 20 131UM0	ORIENTABILE	PORTAPINZA ER20	INTERNA-ESTERNA	i=1:1	UNIVERSALE
VELOCITÀ MOLTIPLICATA	10/MO 	RAPPS 20 122UM0	ASSIALE	PORTAPINZA ER20	ESTERNA	i=1:4	UNIVERSALE
	11/MO 	RRPPS 20 122DM0	RADIALE	PORTAPINZA ER20	ESTERNA	i=1:4	DRITTO
	12/MO 	RRPPS 20 122RM0	RADIALE	PORTAPINZA ER20	ESTERNA	i=1:4	ROVESCiato
	13/MO 	RRPPT 20 122UM0	RADIALE DOPPIO	PORTAPINZA ER20	ESTERNA	i=1:4	DOPPIO

MO

Portautensile rotante, assiale, portapinza ER25, refrigerazione esterna

Driven tool, axial, collet chuck ER25, external coolant supply

Porte-outil tournant, axial, pince de serrage ER25, alimentation d'arrosage extérieur

Angetriebene Werkzeuge, axial, Spannzangeaufnahme ER25, Kühlschmierstoffzuführung extern

$$i = n_1:n_2 = +1 (1:1)$$

RAPPS 25 121UM0

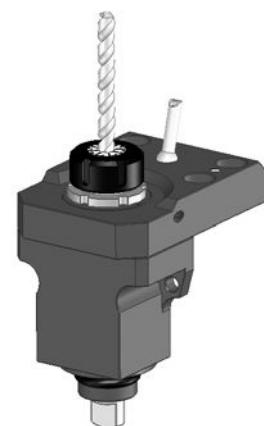
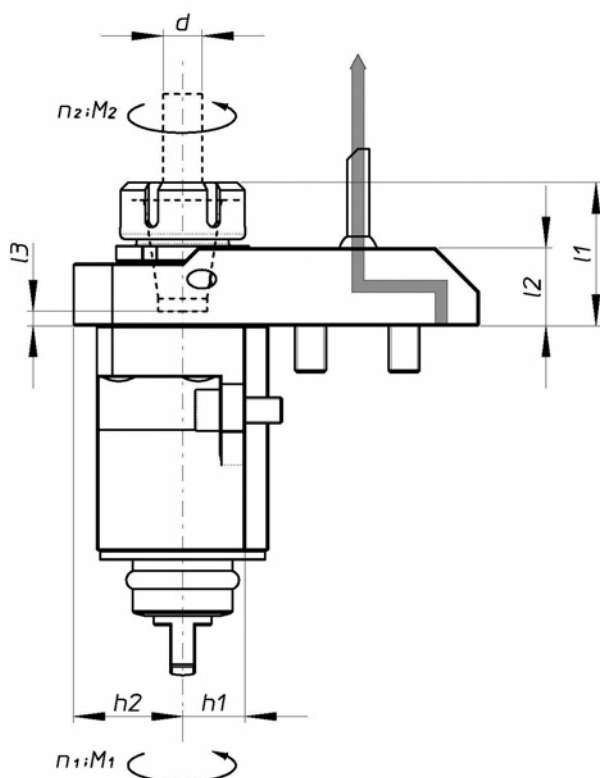

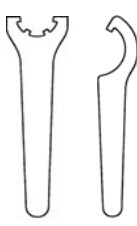
Codice Code - Code - Bestell	M ₂ Nm	n ₂ min-1	p kw	Dimensioni - Dimensions - Dimensions - Maße								Utensili per pinze Tool location for collets Prise d'outil par pince Werkzeug-Aufnahme für Spannzange	Capacità di serraggio d Chucking capacity d Capacité de serrage d Spannbereich d	Chiavi necessarie Necessary keys Clefs nécessaires Erforderliche schlüssel RE25 PZ RE25 QZ + RE25 RZ 
	l ₁ mm	l ₂ mm	l ₃ mm	h ₁ mm	h ₂ mm	h ₃ mm	h ₄ mm	h ₅ mm						
RAPPS 25 121UM0	30	6.000	8	47,5 52	25	-3.5	20	35					DIN 6499-25	

Portautensile rotante, radiale, portapinza ER25, refrigerazione esterna

Driven tool, radial, collet chuck ER25, external coolant supply

Porte-outil tournant, radial, pince de serrage ER25, alimentation d'arrosage extérieur

Angetriebene Werkzeuge, radial, Spannangeaufnahme ER25, Kühlschmierstoffzuführung extern

$$i = n_1:n_2 = +1 (1:1)$$

RRPPS 25 121DMO

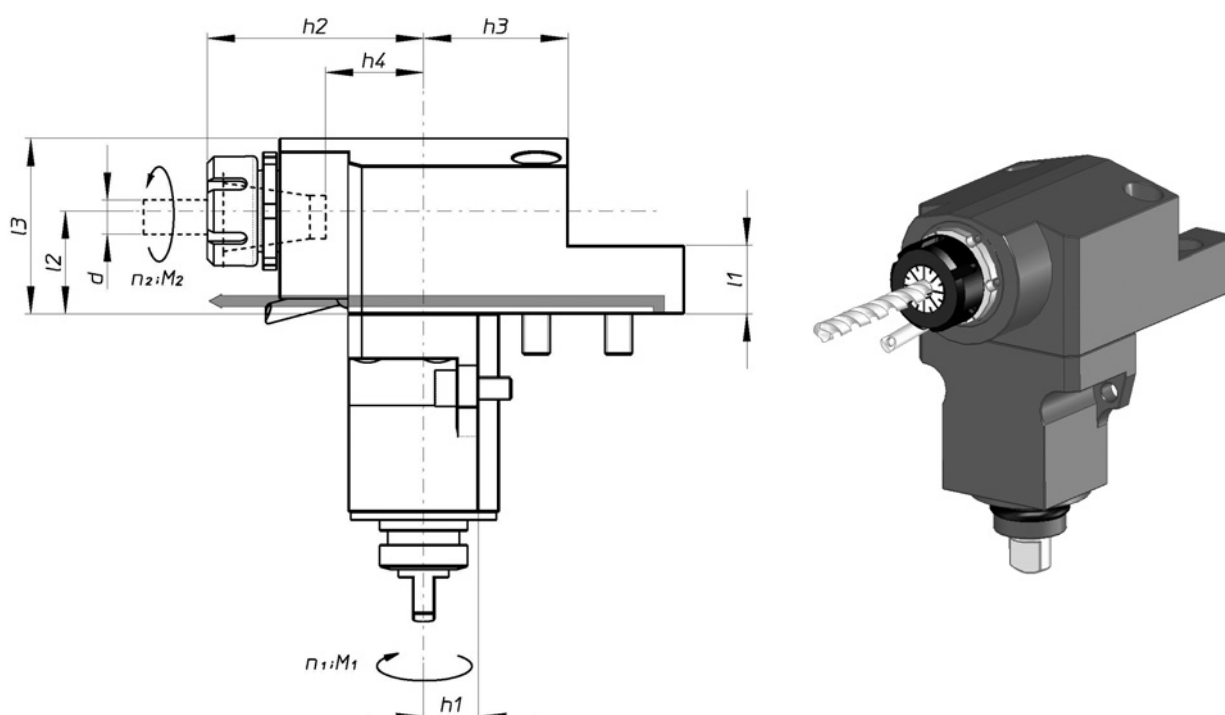

Codice Code - Code - Bestell	M ₂ Nm	n ₂ min-1	p kw	Dimensioni - Dimensions - Dimensions - Maße								Utensili per pinze Tool location for collets Prise d'outil par pince Werkzeug-Aufnahme für Spannange	Capacità di serraggio d Chucking capacity d Capacité de serrage d Spannbereich d
	l ₁ mm	l ₂ mm	l ₃ mm	h ₁ mm	h ₂ mm	h ₃ mm	h ₄ mm	h ₅ mm					
RRPPS 25 121DMO	30	6.000	8	25	37,5	65.5	20	80 84,5	55	29		DIN 6499-25	Chiavi necessarie Necessary keys Clefs nécessaires Erforderliche schlüssel RE25 PZ RE25 QZ + RE25 RZ

Portautensile rotante, radiale rovesciato, portapinza ER25, refrigerazione esterna

Driven tool, radial upside-down, collet chuck ER25, external coolant supply

Porte-outil tournant, radial renversé, pince de serrage ER25, alimentation d'arrosage extérieur

Angetriebene Werkzeuge, radial überkopf, Spannzangeaufnahme ER25, Kühlschmierstoffzuführung extern

$$i = n_1:n_2 = +1 (1:1)$$

RRPPS 25 121RMO

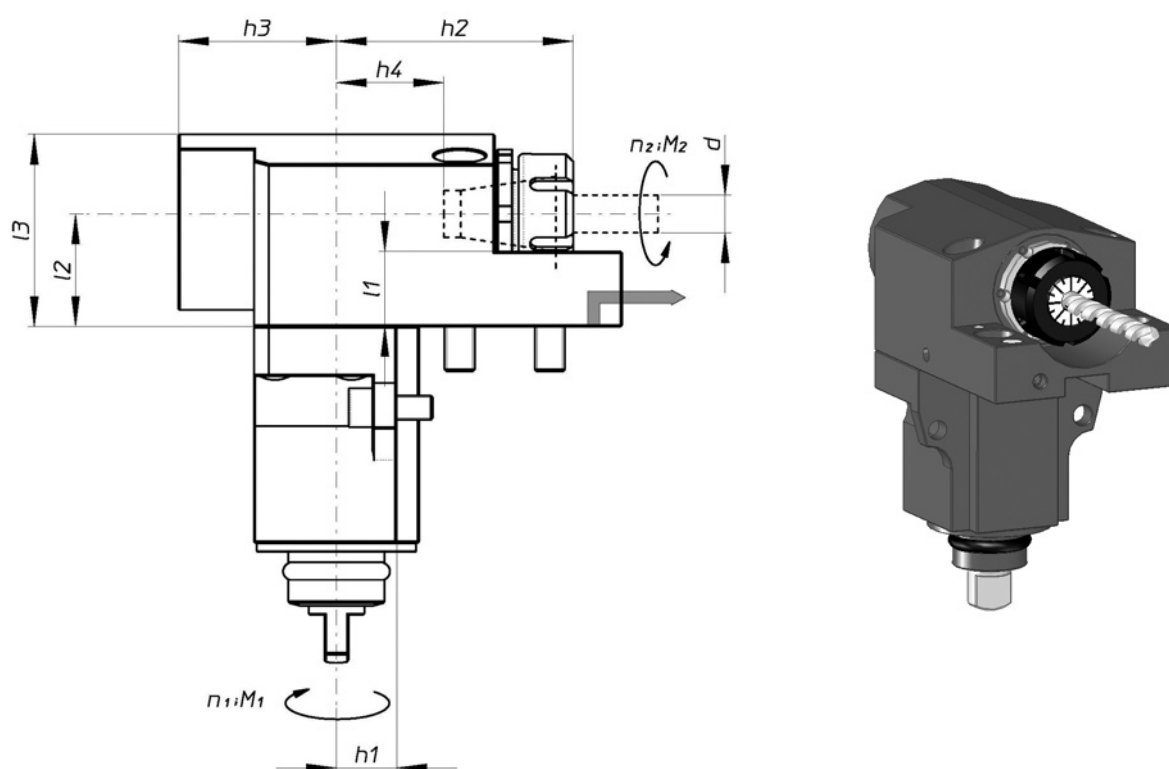

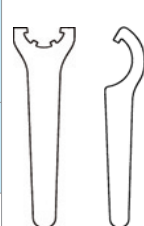
Codice Code - Code - Bestell	M ₂ Nm	n ₂ min-1	p kw	Dimensioni - Dimensions - Dimensions - Maße								Utensili per pinze Tool location for collets Prise d'outil par pince Werkzeug-Aufnahme für Spannzange	Capacità di serraggio d Chucking capacity d Capacité de serrage d Spannbereich d	Chiavi necessarie Necessary keys Clefs nécessaires Erforderliche schlüssel RE25 PZ RE25 QZ + RE25 RZ 
	l ₁ mm	l ₂ mm	l ₃ mm	h ₁ mm	h ₂ mm	h ₃ mm	h ₄ mm	h ₅ mm						
RRPPS 25 121RMO	30	6.000	8	25	37,5	65,5	20	$\frac{80}{84,5}$	55	29		DIN 6499-25		

Portautensile rotante, radiale, portapinza ER25 (doppio), refrigerazione esterna

Driven tool, radial, 2 collet chuck ER25 (double), external coolant supply

Porte-outil tournant, radial, 2 pince de serrage ER25 (double), alimentation d'arrosage extérieur

Angetriebene Werkzeuge, radial, Spannangeaufnahme 2 fach ER25, Kühlschmierstoffzuführung extern

$$i = n_1:n_2 = +1 (1:1)$$

RRPPT 25 121UMO

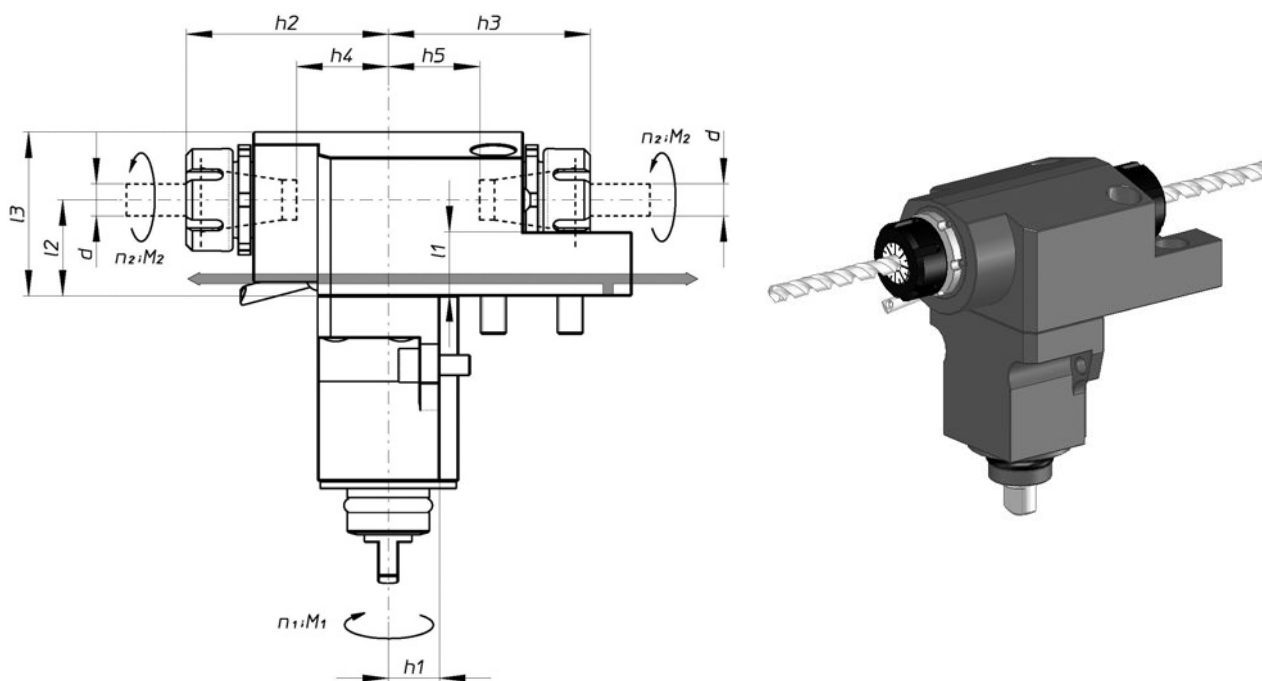

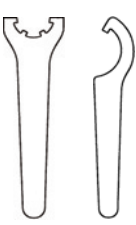
Codice Code - Code - Bestell	M ₂ Nm	n ₂ min-1	p kw	Dimensioni - Dimensions - Dimensions - Maße								Utensili per pinze Tool location for collets Prise d'outil par pince Werkzeug-Aufnahme für Spannange	Capacità di serraggio d Chucking capacity d Capacité de serrage d Spannbereich d
	l ₁ mm	l ₂ mm	l ₃ mm	h ₁ mm	h ₂ mm	h ₃ mm	h ₄ mm	h ₅ mm					
RRPPT 25 121UMO	30	6.000	8	25	37,5	65,5	20	80 84,5	80 84,5	40	40	DIN 6499-25	Chiavi necessarie Necessary keys Cleps nécessaires Erforderliche schlüssel RE25 PZ RE25 QZ + RE25 RZ 

Portautensile rotante orientabile, portapinza ER20, refrigerazione esterna

Driven tool angle adjustable, collet chuck ER20, external coolant supply

Porte-outil tournant angle réglable, pince de serrage ER20, alimentation d'arrosage extérieur

Angetriebene Werkzeuge winkeleinstellbar, Spannzangeaufnahme ER20, Kühlschmierstoffzuführung extern

$$i = n_1:n_2 = +1 (1:1)$$

ROPPS 20 121UM0

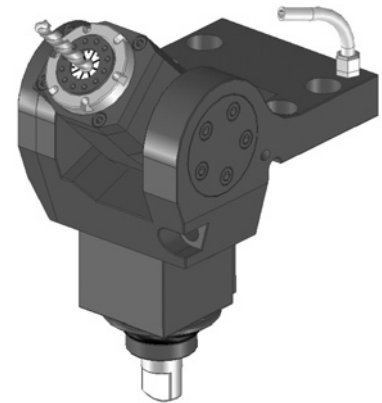
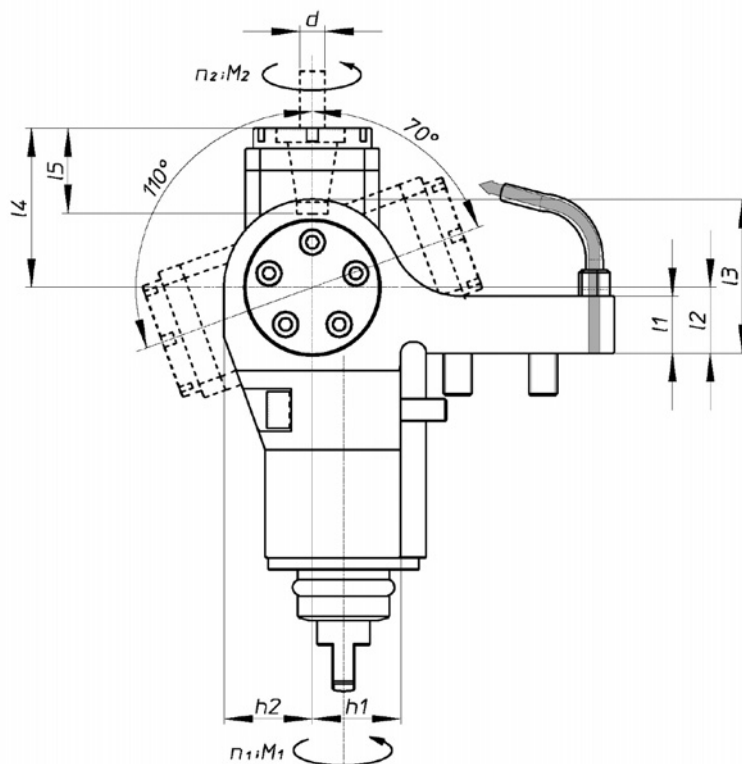

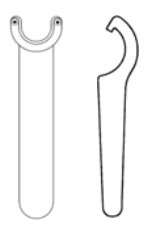
Codice Code - Code - Bestell	M ₂ Nm	n ₂ min-1	p kw	Dimensioni - Dimensions - Dimensions - Maße							Utensili per pinze Tool location for collets Prise d'outil par pince Werkzeug-Aufnahme für Spannzange		Chiavi necessarie Necessary keys Cleps nécessaires Erforderliche schlüssel
	h ₂ mm	h ₁ mm	l ₁ mm	l ₂ mm	l ₃ mm	l ₄ mm	l ₅ mm	h ₁ mm	h ₂ mm	Capacità di serraggio d Clutching capacity d Capacité de serrage d Spannbereich d	RE20 IZ RE20 HZ + RE20 RZ		
ROPPS 20 121UM0	20	6.000	6	20	23,07	54	56	37,5	30,95	31	DIN 6499-20		

Portautensile rotante, assiale, portapinza ER25, refrigerazione interna-esterna

Driven tool, axial, collet chuck ER25, external and internal coolant supply

Porte-outil tournant, axial, pince de serrage ER25, alimentation d'arrosage extérieur et intérieur

Angetriebene Werkzeuge, axial, Spannzangeaufnahme ER25, Kühlschmierstoffzuführung extern und intern

$$i = n_1:n_2 = +1 (1:1)$$

RAPPS 25 131UMO

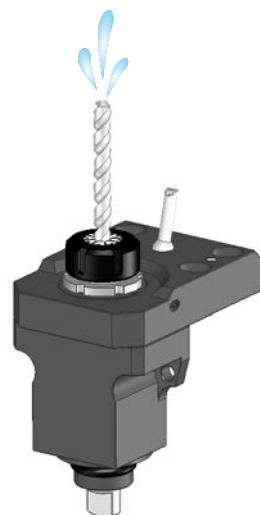
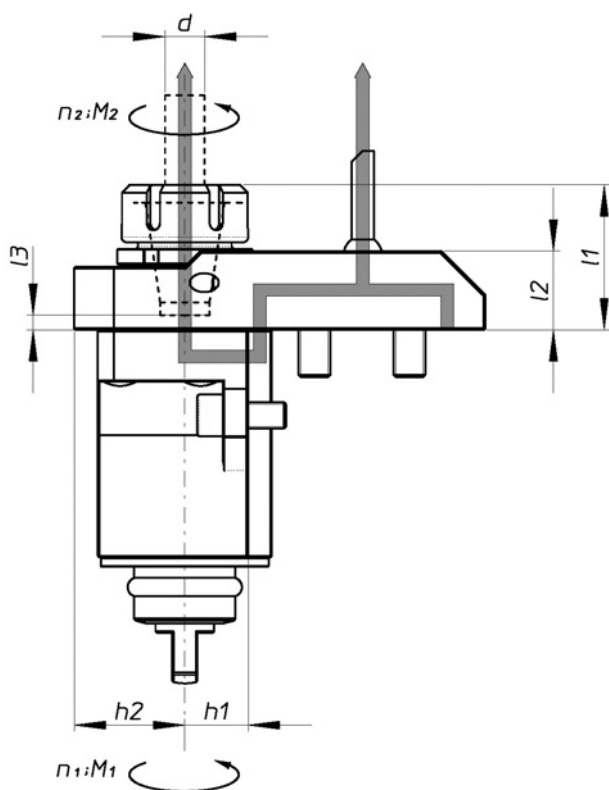

pressione refrigerante
coolant pressure
pression d'arrosage max. 70 BAR
kühlschmierstoffdruck

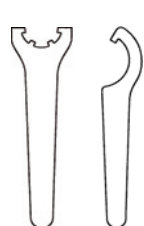
Codice Code - Code - Bestell	M ₂ Nm	n ₂ min ⁻¹	p kw	Dimensioni - Dimensions - Dimensions - Maße								Utensili per pinze Tool location for collets Prise d'outil par pince Werkzeug-Aufnahme für Spannzange	Chiavi necessarie Necessary keys Cleps nécessaires Erforderliche schlüssel RE25 PZ RE25 QZ + RE25 RZ
	Momento torcente max. Max. torque Couple de rotation de l'outil Max. Drehmoment	Velocità max. utensile Max. tool speed Vitesse max. de rotation de l'outil Max. Drehzahl	Capacità max. Max. capacity Capacité max. Max. Leistung	l ₁ mm	l ₂ mm	l ₃ mm	h ₁ mm	h ₂ mm	h ₃ mm	h ₄ mm	h ₅ mm		
RAPPS 25 131UMO	30	6.000	8	47,5 52	25	-3.5	20	35				DIN 6499-25	

Portautensile rotante, radiale, portapinza ER25, refrigerazione interna-esterna

Driven tool, radial, collet chuck ER25, external and internal coolant supply

Porte-outil tournant, radial, pince de serrage ER25, alimentation d'arrosage extérieur et intérieur

Angetriebene Werkzeuge, radial, Spannzangeaufnahme ER25, Kühlschmierstoffzuführung extern und intern

$$i = n_1:n_2 = +1 (1:1)$$

RRPPS 25 131DMO

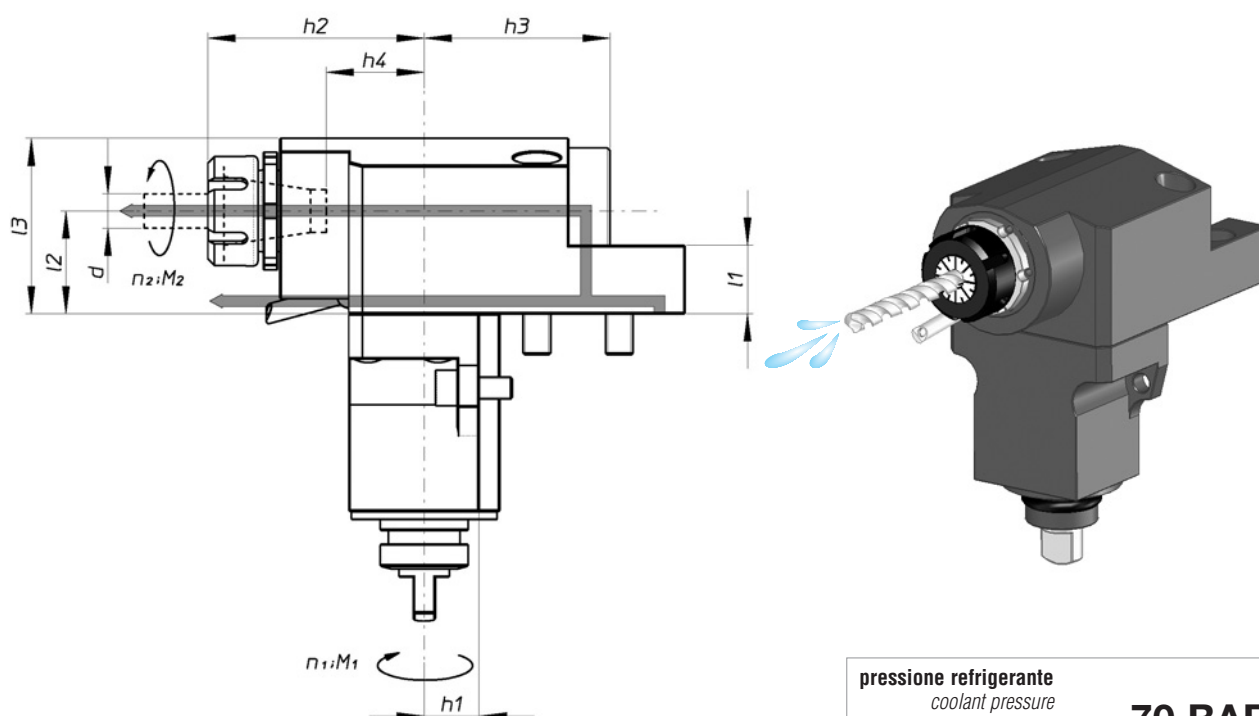

pressione refrigerante
coolant pressure
pression d'arrossage **max. 70 BAR**
kühlschmierstoffdruck

Codice <i>Code - Code - Bestell</i>	M ₂ Nm	n ₂ min-1	p kw	Dimensioni - Dimensions - Dimensions - Maße								Utensili per pinze <i>Tool location for collets</i> <i>Prise d'outil pour pince</i> <i>Werkzeug-Aufnahme für Spannzange</i>	Chiavi necessarie <i>Necessary keys</i> <i>Clefs nécessaires</i> <i>Erforderliche schlüssel</i>
	l ₁ mm	l ₂ mm	l ₃ mm	h ₁ mm	h ₂ mm	h ₃ mm	h ₄ mm	h ₅ mm	Capacità di serraggio d <i>Clutching capacity d</i> <i>Capacité de serrage d</i> <i>Spannbereich d</i>				
RRPPS 25 131DMO	30	6.000	8	25	37,5	65.5	20	80 84,5	70	29		DIN 6499-25	RE25 PZ RE25 QZ + RE25 RZ



Portautensile rotante, radiale rovesciato, portapinza ER25, refrigerazione interna-esterna
Driven tool, radial upside-down, collet chuck ER25, external and internal coolant supply
Porte-outil tournant, radial renversé, pince de serrage ER25, alimentation d'arrosage extérieur et intérieur
Angetriebene Werkzeuge, radial überkopf, Spannzangeaufnahme ER25, Kühlschmierstoffzuführung extern und intern

$$i = n_1:n_2 = +1 (1:1)$$

RRPPS 25 131RMO

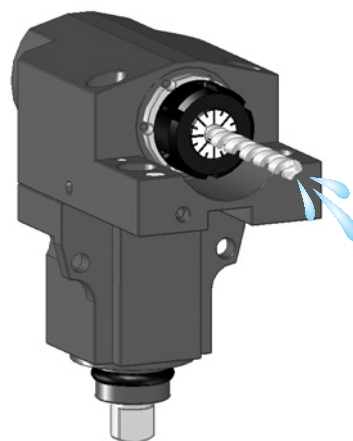
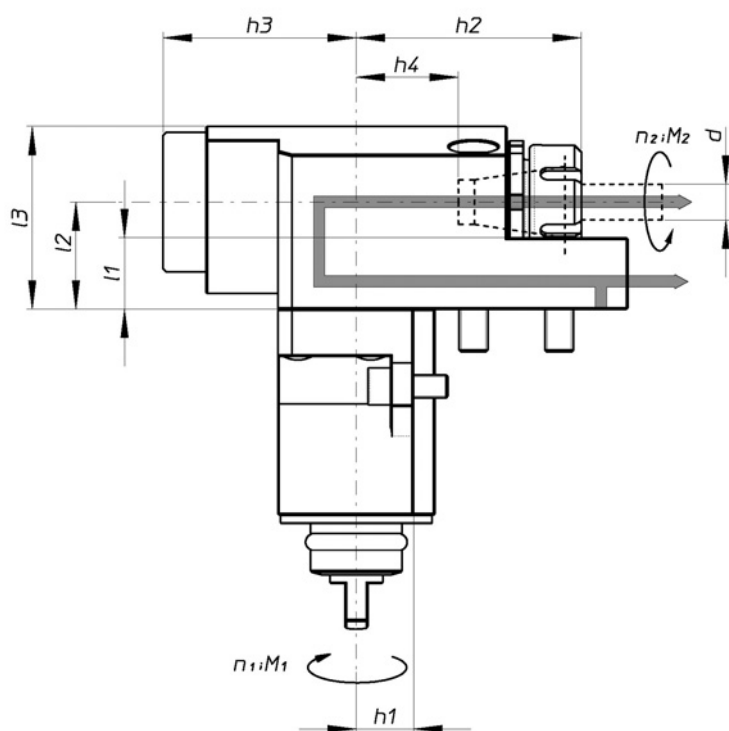

pressione refrigerante
coolant pressure
pression d'arrosage **max. 70 BAR**
kühlschmierstoffdruck

Codice Code - Code - Bestell	M ₂ Nm	n ₂ min-1	p kw	Dimensioni - Dimensions - Dimensions - Maße								Utensili per pinze Tool location for collets Prise d'outil par pince Werkzeug-Aufnahme für Spannzange	Chiavi necessarie Necessary keys Cleps nécessaires Erforderliche schlüssel
	l ₁ mm	l ₂ mm	l ₃ mm	h ₁ mm	h ₂ mm	h ₃ mm	h ₄ mm	h ₅ mm	Capacità di serraggio d Chucking capacity d Capacité de serrage d Spannbereich d	RE25 PZ			
RRPPS 25 131RMO	30	6.000	8	25	37,5	65,5	20	80 84,5	70	29	DIN 6499-25	RE25 QZ + RE25 RZ	

Portautensile rotante orientabile, portapinza ER20, refrigerazione interna-esterna
Driven tool angle adjustable, collet chuck ER20, external and internal coolant supply
Porte-outil tournant angle réglable, pince de serrage ER20, alimentation d'arrosage extérieur et intérieur
Angetriebene Werkzeuge winkeleinstellbar, Spannzangeaufnahme ER20, Kühlschmierstoffzuführung extern und intern

$$i = n_1:n_2 = +1 (1:1)$$

ROPPS 20 131UMO

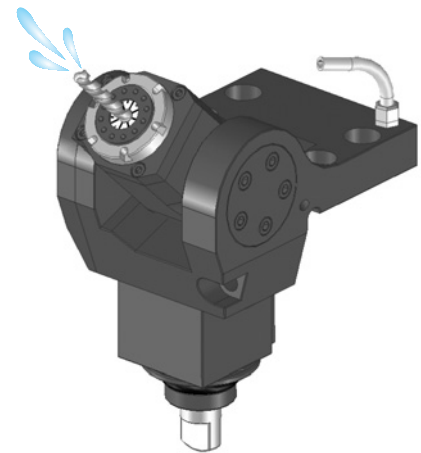
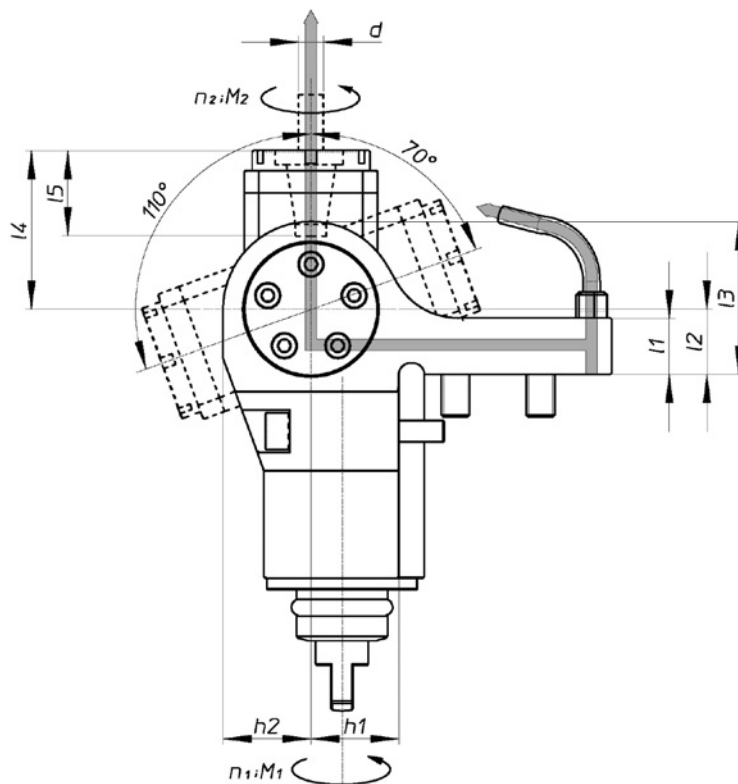

pressione refrigerante
coolant pressure
pression d'arrosage **max. 70 BAR**
kühlschmierstoffdruck

Codice Code - Code - Bestell	M ₂ Nm	n ₂ min-1	p kw	Dimensioni - Dimensions - Dimensions - Maße							Utensili per pinze Tool location for collets Prise d'outil pour pince Werkzeug-Aufnahme für Spannzange		Chiavi necessarie Necessary keys Clefs nécessaires Erforderliche schlüssel
	l ₁ mm	l ₂ mm	l ₃ mm	l ₄ mm	l ₅ mm	h ₁ mm	h ₂ mm	Capacità di serraggio d Chucking capacity d Capacité de serrage d Spannbereich d	RE20 IZ RE20 HZ + RE20 RZ				
ROPPS 20 131UMO	20	6.000	6	20	23,07	54	56	37,5	30,95	31	DIN 6499-20		

Portautensile rotante, assiale, portapinza ER20, refrigerazione esterna, velocità moltiplicata

Driven tool, axial, collet chuck ER20, external coolant supply, high transmission ratio

Porte-outil tournant, axial, pince de serrage ER20, alimentation d'arrosage extérieur, grande vitesse

Angetriebene Werkzeuge, axial, Spannzangeaufnahme ER20, Kühlschmierstoffzuführung extern, ins Schnelle

$$i = n_1:n_2 = +0,25 (1:4)$$

RAPPS 20 122UMO

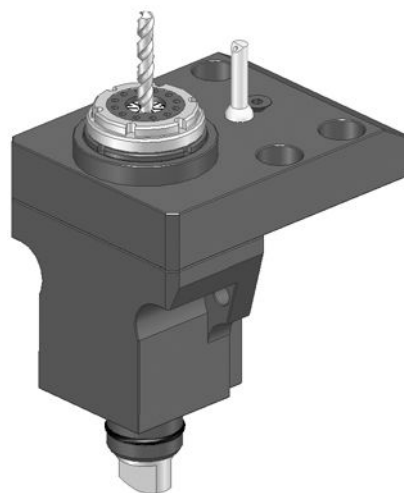
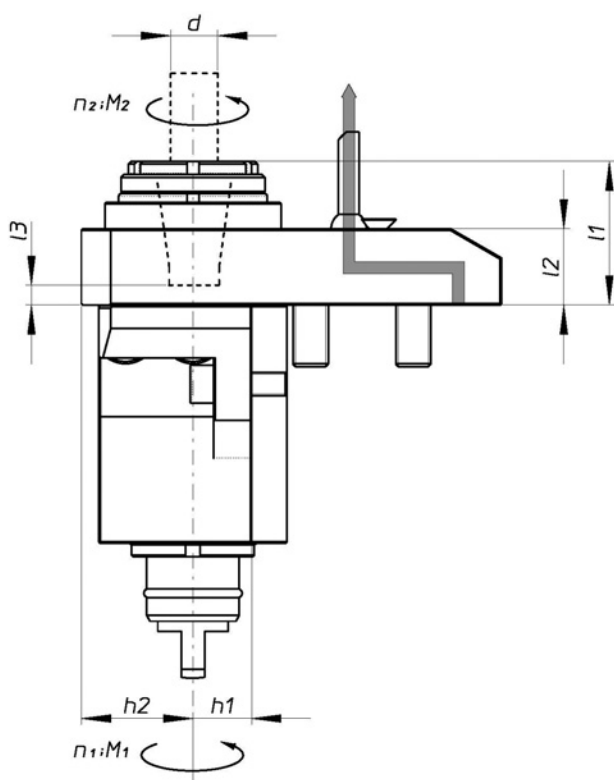

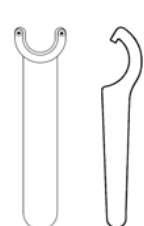
Codice Code - Code - Bestell	M ₂ Nm	n ₂ min-1	p kw	Dimensioni - Dimensions - Dimensions - Maße					Utensili per pinze Tool location for collets Prise d'outil par pince Werkzeug-Aufnahme für Spannzange		Chiavi necessarie Necessary keys Cleps nécessaires Erforderliche schlüssel RE20 IZ RE20 HZ + RE20 RZ		
	Momento torcente max. Max. torque Couple de rotation de l'outil Max. Drehmoment	Velocità max. utensile Max. tool speed Vitesse max. de rotation de l'outil Max. Drehzahl	Capacità max. Max. capacity Capacité max. Max. Leistung	l ₁ mm	l ₂ mm	l ₃ mm	h ₁ mm	h ₂ mm	h ₃ mm	h ₄ mm		h ₅ mm	Capacità di serraggio d Chucking capacity d Capacité de serrage d Spannbereich d
RAPPS 20 122UMO	4	16.000	3	50	25	9	20	35				DIN 6499-20	



Portautensile rotante, radiale, portapinza ER20, refrigerazione interna, velocità moltiplicata

Driven tool, radial, collet chuck ER20, external coolant supply, high transmission ratio

Porte-outil tournant, radial, pince de serrage ER20, alimentation d'arrosage extérieur, grande vitesse

Angetriebene Werkzeuge, radial, Spannzangeaufnahme ER20, Kühlschmierstoffzuführung extern, ins Schnelle

$$i = n_1:n_2 = +0,25 (1:4)$$

RRPPS 20 122DMO

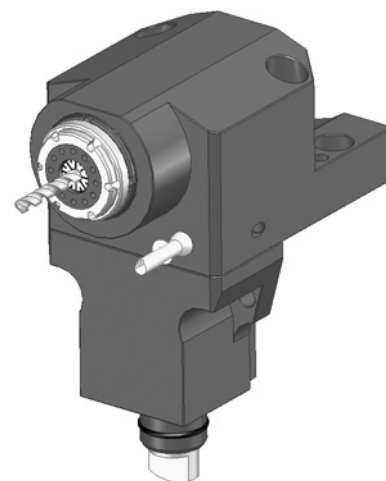
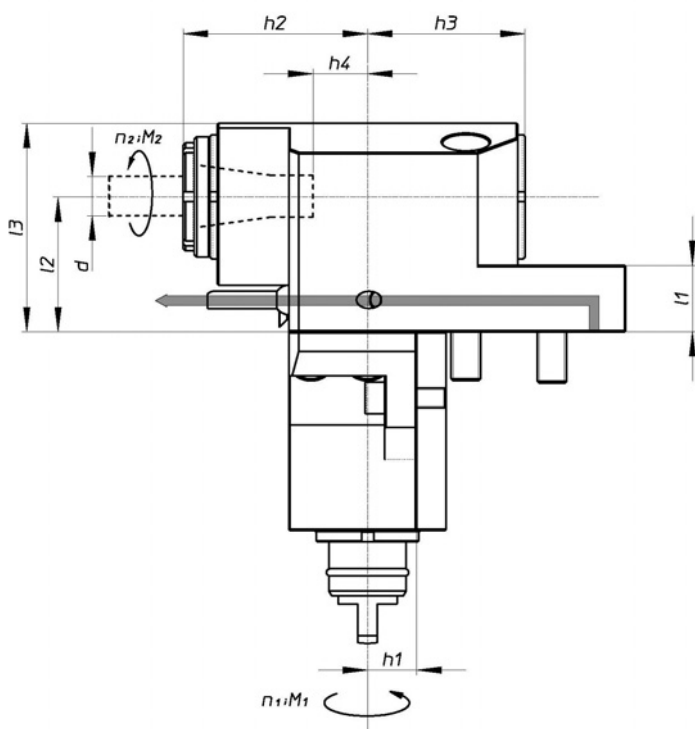

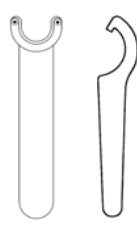
Codice Code - Code - Bestell	M ₂ Nm	n ₂ min-1	p kw	Dimensioni - Dimensions - Dimensions - Maße							Utensili per pinze Tool location for collets Prise d'outil par pince Werkzeug-Aufnahme für Spannzange	Capacità di serraggio d Chucking capacity d Capacité de serrage d Spannbereich d	Chiavi necessarie Necessary keys Clefs nécessaires Erforderliche schlüssel RE25 IZ RE20 HZ + RE20 RZ 
	l ₁ mm	l ₂ mm	l ₃ mm	h ₁ mm	h ₂ mm	h ₃ mm	h ₄ mm	h ₅ mm					
RRPPS 20 122DMO	4	16.000	3	25	37,5	65,5	20	72	60	31	DIN 6499-20		

Portautensile rotante, radiale rovesciato, portapinza ER20, refrigerazione esterna, velocità moltiplicata
Driven tool, radial upside-down, collet chuck ER20, external coolant supply, high transmission ratio
Porte-outil tournant, radial renversé, pince de serrage ER20, alimentation d'arrosage extérieur, grande vitesse
Angetriebene Werkzeuge, radial überkopf, Spannzangeaufnahme ER20, Kühlschmierstoffzuführung extern, ins Schnelle

$$i = n_1:n_2 = +0,25 (1:4)$$

RRPPS 20 122RMO

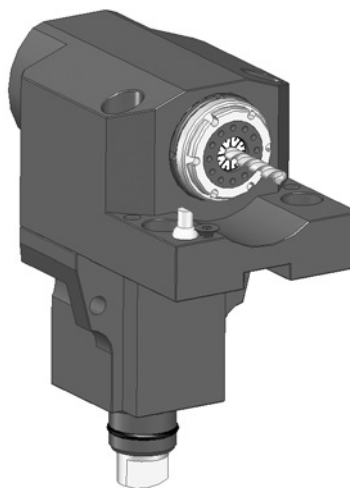
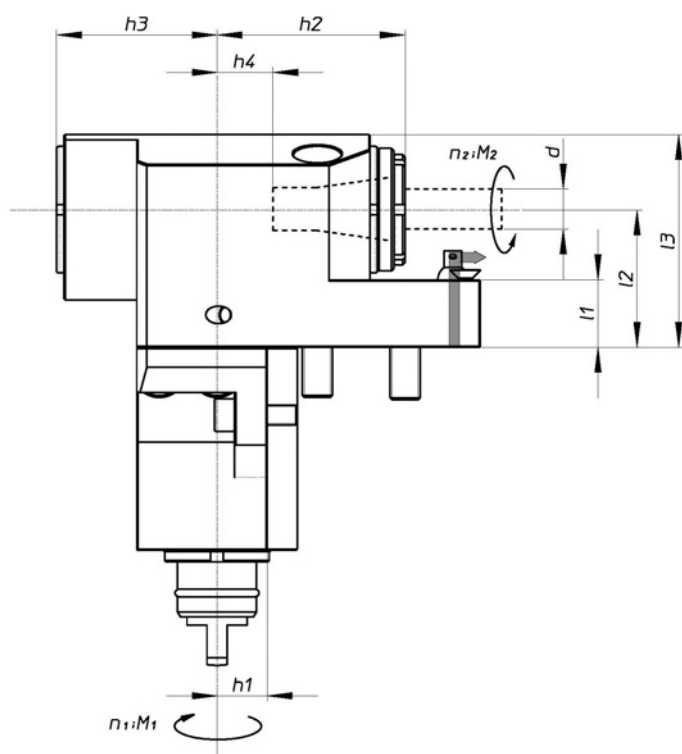

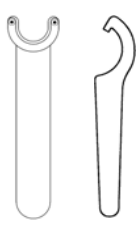
Codice Code - Code - Bestell	Momento torcente max. Max. torque Couple de rotation de l'outil Max. Drehmoment	Velocità max. utensile Max. tool speed Vitesse max. de rotation de l'outil Max. Drehzahl	Capacità max. Max. capacity Capacité max. Max. Leistung	Dimensioni - Dimensions - Dimensions - Maße							Utensili per pinze Tool location for collets Prise d'outil par pince Werkzeug-Aufnahme für Spannzange	Chiavi necessarie Necessary keys Cleps nécessaires Erforderliche schlüssel	
	M ₂ Nm	n ₂ min-1	p kw	l ₁ mm	l ₂ mm	l ₃ mm	h ₁ mm	h ₂ mm	h ₃ mm	h ₄ mm	h ₅ mm	Capacità di serraggio d Chucking capacity d Capacité de serrage d Spannbereich d	RE25 IZ RE20 HZ + RE20 RZ
RRPPS 20 122RMO	4	16.000	3	25	37,5	65,5	20	72	60	31		DIN 6499-20	

Portautensile rotante, radiale, portapinza ER20 (doppio), refrigerazione esterna, velocità moltiplicata
Driven tool, radial, 2 collet chuck ER20 (double), external coolant supply, high transmission ratio

Porte-outil tournant, radial, 2 pince de serrage ER20 (double), alimentation d'arrosage extérieur, grande vitesse

Angetriebene Werkzeuge, radial, Spannzangeaufnahme 2 fach ER20, Kühlschmierstoffzuführung extern, ins Schnelle

$$i = n_1:n_2 = +0,25 (1:4)$$

RRPPT 20 122UM0

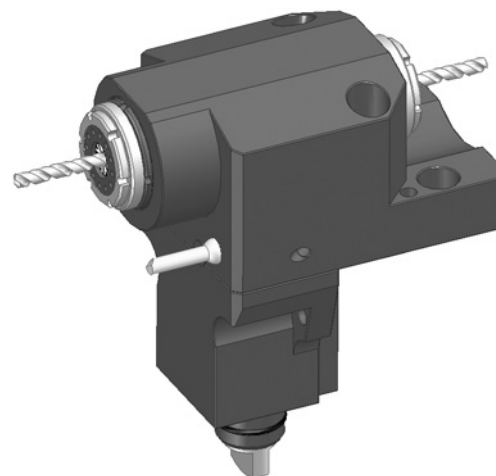
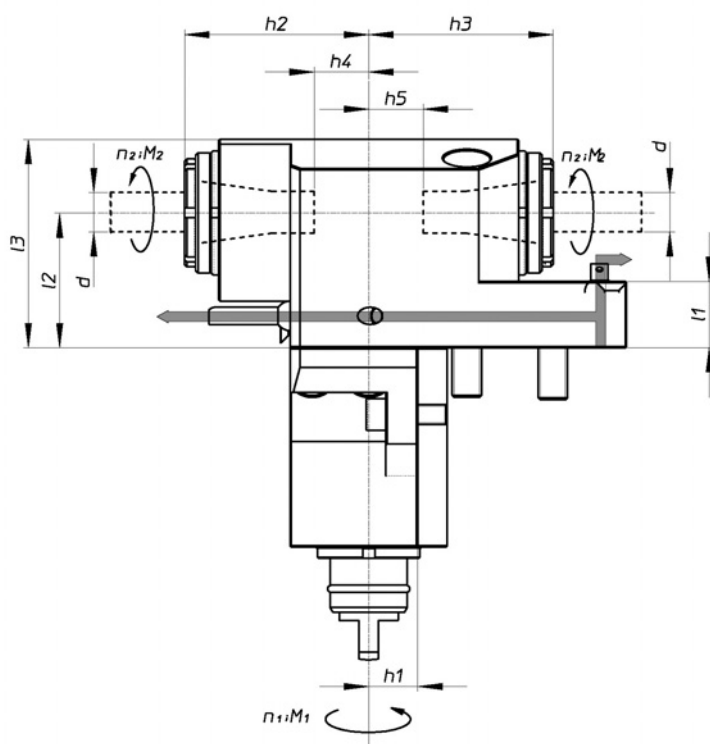

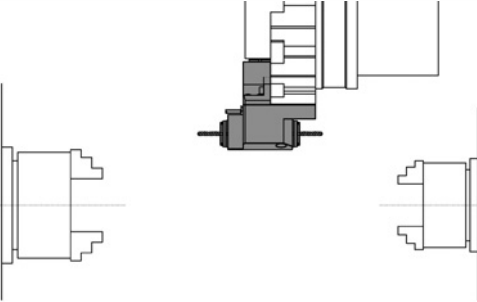
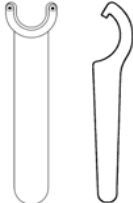
Codice Code - Code - Bestell	M ₂ Nm	n ₂ min-1	p kw	 Dimensioni - Dimensions - Dimensions - Maße							Utensili per pinze Tool location for collets Prise d'outils par pince Werkzeug-Aufnahme für Spannzange		Chiavi necessarie Necessary keys Clefs nécessaires Erforderliche schlüssel RE25 IZ RE20 HZ + RE20 RZ
	Momento torcente max. Max. torque Couple de rotation de l'outil Max. Drehmoment	Velocità max. utensile Max. tool speed Vitesse max. de rotation de l'outil Max. Drehzahl	Capacità max. Max. capacity Capacité max. Max. Leistung	l ₁ mm	l ₂ mm	l ₃ mm	h ₁ mm	h ₂ mm	h ₃ mm	h ₄ mm	h ₅ mm	Capacità di serraggio d Chucking capacity d Capacité de serrage d Spannbereich d	
RRPPT 20 122UM0	4	16.000	3	25	37,5	65,5	20	72	72	31	31	DIN 6499-20	