

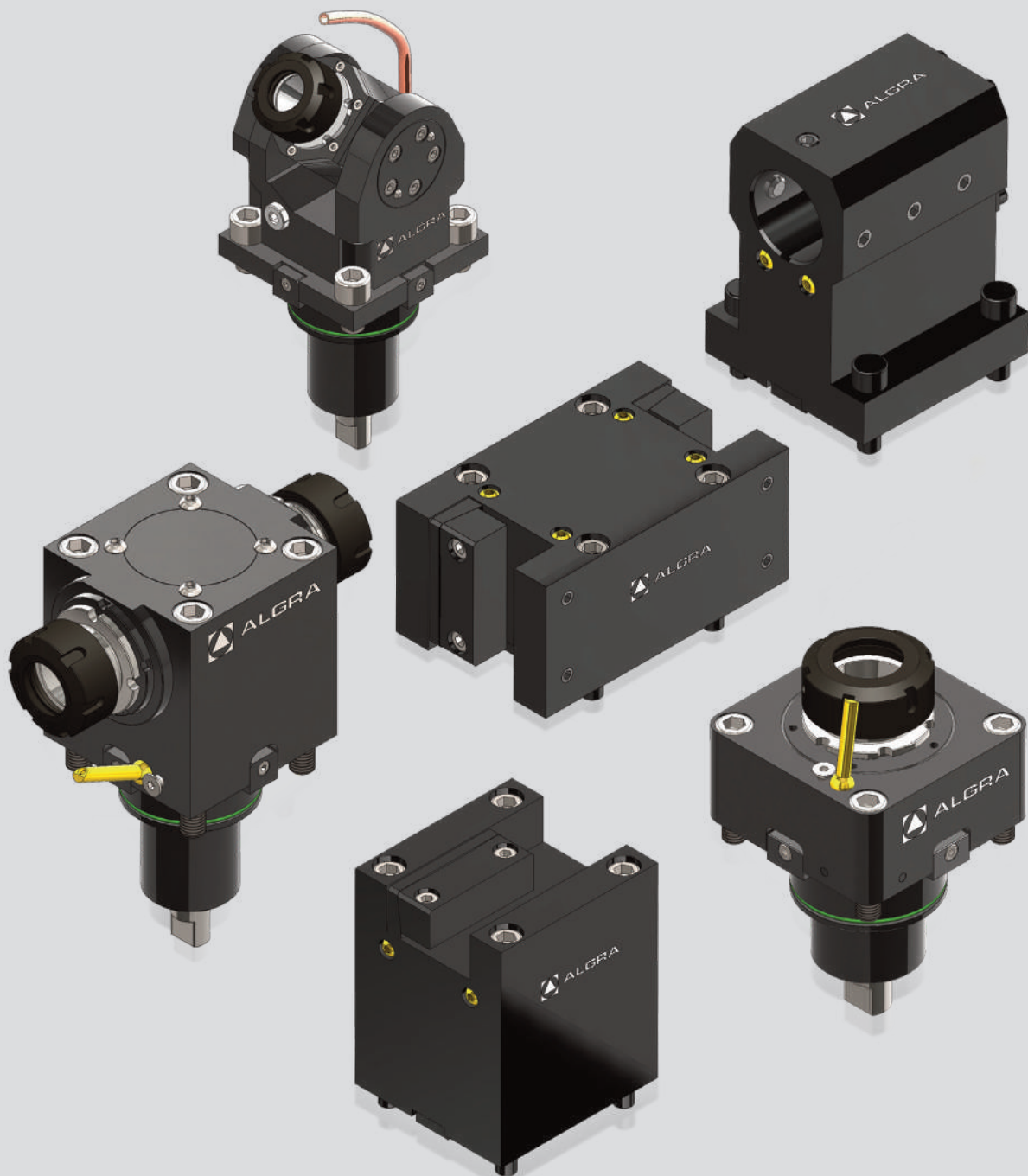



Toolholder Program





# BMT75



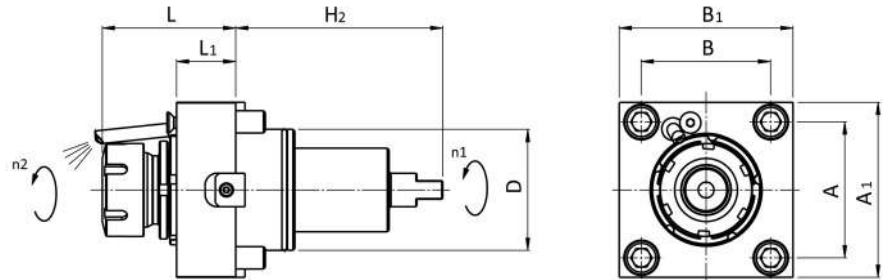



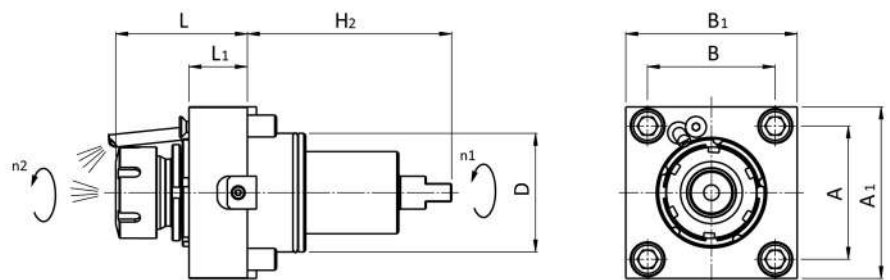
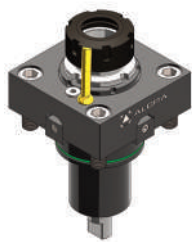

BMT75	Version	Tools Clamping	Center Height	Max. speed	Ratio	External	Internal	Page
	0°	ER40 - DIN6499		6000rpm	i=1:1	RAPPS 40 121UT75	RAPPS 40 131UT75	4
	90°	ER40 - DIN6499	60mm	6000rpm	i=1:1	RRPPS 40 121UT75	RRPPS 40 131UT75	5
		ER40 - DIN6499	90mm	6000rpm	i=1:1	RRPPS 40 321UT75	RRPPS 40 331UT75	5
		ER40 - DIN6499	110mm	6000rpm	i=1:1	RRPPS 40 421UT75	RRPPS 40 431UT75	5
		Ø27mm - DIN6358	60mm	6000rpm	i=1:1	RRPFS 27 121UT75		6
		Ø27mm - DIN6358	90mm	6000rpm	i=1:1	RRPFS 27 321UT75		6
		Ø27mm - DIN6358	110mm	6000rpm	i=1:1	RRPFS 27 421UT75		6
	90° double	ER40 - DIN6499	60mm	6000rpm	i=1:1	RRPPT 40 121UT75		6
		ER40 - DIN6499	90mm	6000rpm	i=1:1	RRPPT 40 321UT75		6
		ER40 - DIN6499	110mm	6000rpm	i=1:1	RRPPT 40 421UT75		6
	±90°	ER25 - DIN6499		6000rpm	i=1:1	ROPFS 25 121UT75	ROPFS 25 131UT75	7

<b>BMT75</b>	<b>Version</b>	<b>Tools Clamping</b>	<b>Center Height</b>	<b>Coolant</b>	<b>ALGRA Part No.</b>	<b>Page</b>
	O.D. cutting holder	□ 32mm	H:85mm	External	E10/U 32 T75X85	8
		□ 1.25"	H:85mm	External	E10/U 1.25" T75X85	8
	O.D. double holder	□ 32mm	H:85mm	External	E10/UD 32 T75X85	8
		□ 1.25"	H:85mm	External	E10/UD 1.25" T75X85	8
	Face and I.D. cutting holder	□ 32mm	H:70mm	External	E10/UA 32 T75X70	9
		□ 1.25"	H:70mm	External	E10/UA 1.25" T75X70	9
	Boring Bar holder	∅ 50mm	H:60mm	Int/Ext	E10/B 50 T75X60	9
		∅ 60mm	H:60mm	Int/Ext	E10/B 60 T75X60	9
		∅ 2"	H:60mm	Int/Ext	E10/B 2" T75X60	9
		∅ 2.5"	H:60mm	Int/Ext	E10/B 2.5" T75X60	9
		∅ 50mm	H:110mm	Int/Ext	E10/B 50 T75X110	9
		∅ 60mm	H:110mm	Int/Ext	E10/B 60 T75X110	9
		∅ 2"	H:110mm	Int/Ext	E10/B 2" T75X110	9
		∅ 2.5"	H:110mm	Int/Ext	E10/B 2.5" T75X110	9





1/BMT75			Codice	D	ER	H	H1	H2	L	L1	L2	A	B	A1	B1	A2	B2	M <sub>2</sub>	n <sub>2</sub>	P
			code - code - Bestell Nr.						(min-max)									Nm	min-1	kW
  			<b>RAPPS 40 121UT75</b>	75	40			110	86,5-90,2	52,6		90	90	112	112			100	6000	12
																				



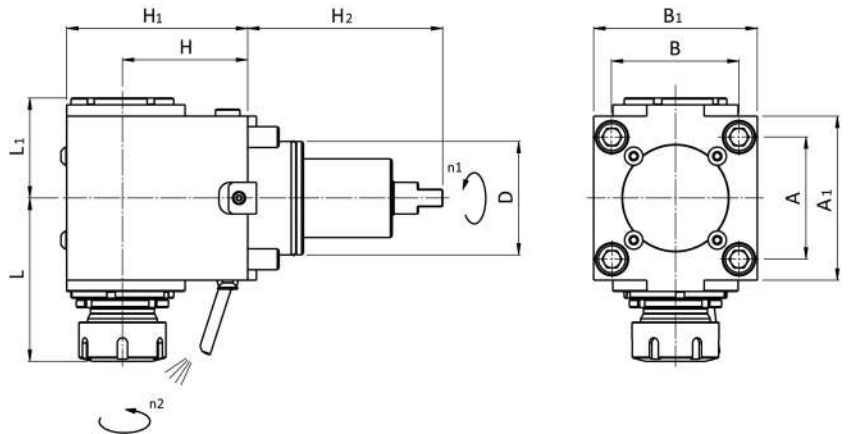



2/BMT75			Codice	D	ER	H	H1	H2	L	L1	L2	A	B	A1	B1	A2	B2	M <sub>2</sub>	n <sub>2</sub>	P
			code - code - Bestell Nr.						(min-max)									Nm	min-1	kW
  			<b>RAPPS 40 131UT75</b>	75	40			110	86,5-90,2	52,6		90	90	112	112			100	6000	12
  																				

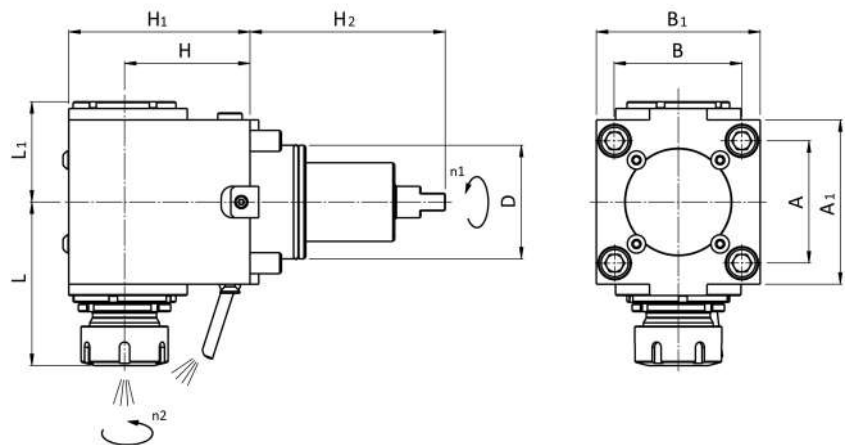





3/BMT75			Codice	D	ER	H	H1	H2	L	L1	L2	A	B	A1	B1	A2	B2	M <sub>2</sub>	n <sub>2</sub>	P	
			code - code - Bestell Nr.						(min-max)									Nm	min-1	kW	
90°			RRPPS 40 121UT75	75	40	60	107	110	108,3÷112,1	74,1		90	90	112	112			100	6000	12	
			RRPPS 40 321UT75	75	40	90	137	110	108,3÷112,1	74,1			90	90	112	112			100	6000	12
			RRPPS 40 421UT75	75	40	110	157	110	108,3÷112,1	74,1			90	90	112	112			100	6000	12
																					

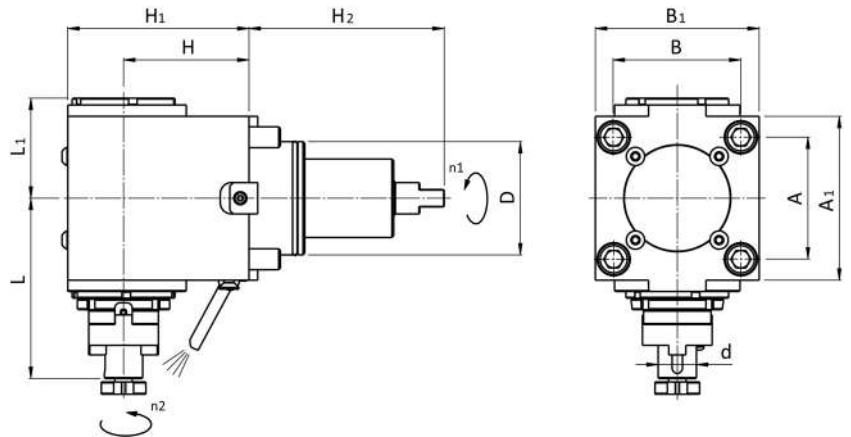





4/BMT75			Codice	D	ER	H	H1	H2	L	L1	L2	A	B	A1	B1	A2	B2	M <sub>2</sub>	n <sub>2</sub>	P	
			code - code - Bestell Nr.						(min-max)									Nm	min-1	kW	
90°			RRPPS 40 131UT75	75	40	60	107	110	108,3÷112,1	74,1		90	90	112	112			100	6000	12	
			RRPPS 40 331UT75	75	40	90	137	110	108,3÷112,1	74,1			90	90	112	112			100	6000	12
			RRPPS 40 431UT75	75	40	110	157	110	108,3÷112,1	74,1			90	90	112	112			100	6000	12
																					

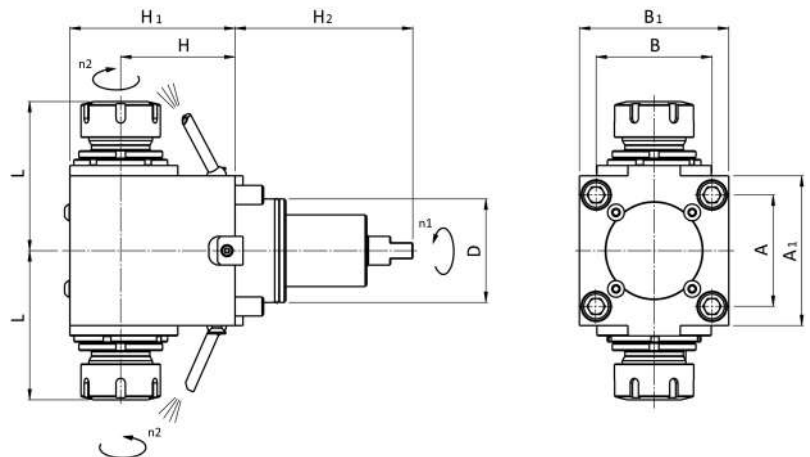





5/BMT75			Codice	D	d	H	H1	H2	L	L1	L2	A	B	A1	B1	A2	B2	M <sub>2</sub>	n <sub>2</sub>	P	
			code - code - Bestell Nr.															Nm	1	kW	
   -1 (1:1)	 EXTERNAL	RRPFS 27 121UT75	75	Ø27	60	107	110	120	74,1			90	90	112	112			100	6000	12	
		RRPFS 27 321UT75	75	Ø27	90	137	110	120	74,1				90	90	112	112			100	6000	12
		RRPFS 27 421UT75	75	Ø27	110	157	110	120	74,1				90	90	112	112			100	6000	12

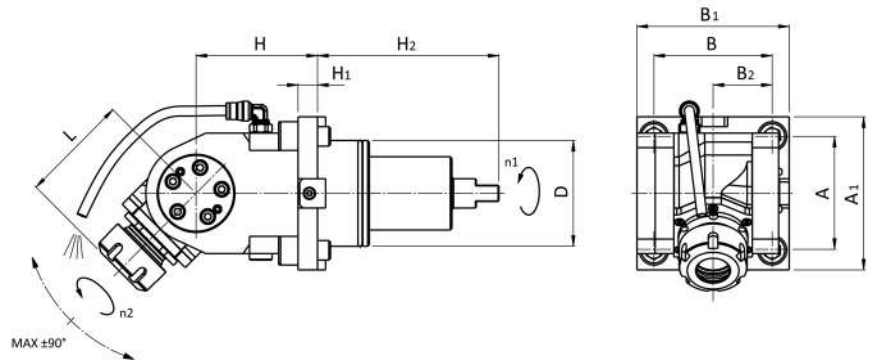



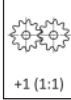

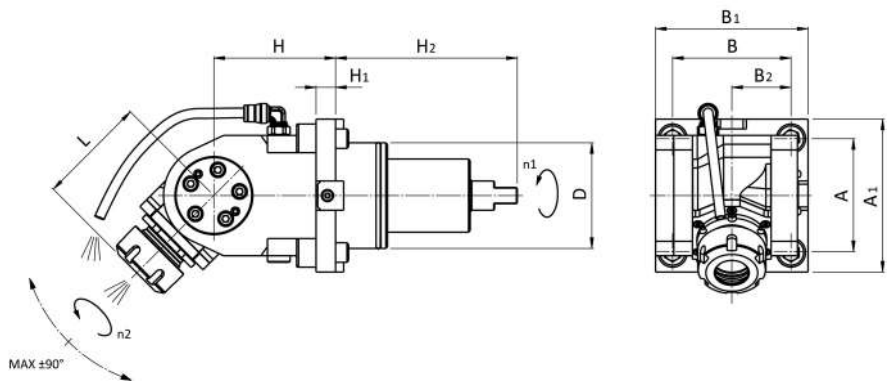

6/BMT75			Codice	D	ER	H	H1	H2	L	L1	L2	A	B	A1	B1	A2	B2	M <sub>2</sub>	n <sub>2</sub>	P	
			code - code - Bestell Nr.						(min-max)									Nm	min-1	kW	
   ±1 (1:1)	 EXTERNAL	RRPPT 40 121UT75	75	40	60	107	110	108,4-112,1				90	90	132	112			100	6000	12	
		RRPPT 40 321UT75	75	40	90	137	110	108,4-112,1					90	90	132	112			100	6000	12
		RRPPT 40 421UT75	75	40	110	157	110	108,4-112,1					90	90	132	112			100	6000	12



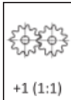

7/BMT75			Codice	D	ER	H	H1	H2	L	L1	L2	A	B	A1	B1	A2	B2	M <sub>2</sub>	n <sub>2</sub>	P
			code - code - Bestell Nr.						(min-max)									Nm	min-1	kW
  			ROPPS 25 121UT75	75	25	75	12	110	63,5-67,2			90	90	105	105		45	25	6000	4
																				



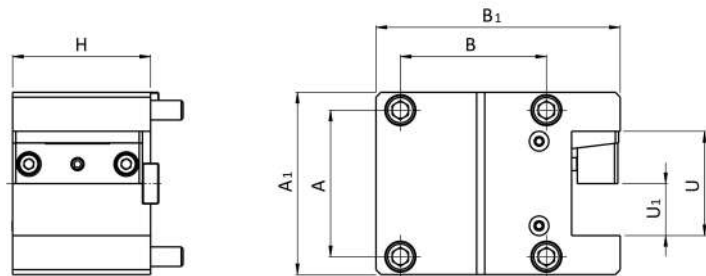

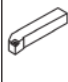
8/BMT75			Codice	D	ER	H	H1	H2	L	L1	L2	A	B	A1	B1	A2	B2	M <sub>2</sub>	n <sub>2</sub>	P
			code - code - Bestell Nr.						(min-max)									Nm	min-1	kW
  			ROPPS 25 131UT75	75	25	75	12	110	63,5-67,2			90	90	105	105		45	25	6000	4
  																				



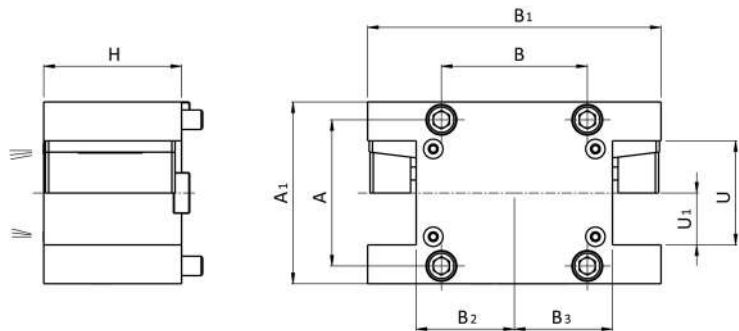

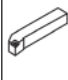
101/BMT75		Codice code - code - Bestell Nr.	U	U1	U2	H	H1	H2	H3	A	B	A1	B1	A2	B2	B3
  EXTERNAL	<b>E10/U 32 T75X85</b>		64	32		85				90	90	112	150			
	<b>E10/U 1.25" T75X85</b>		2.5"	1.25"		85				90	90	112	150			



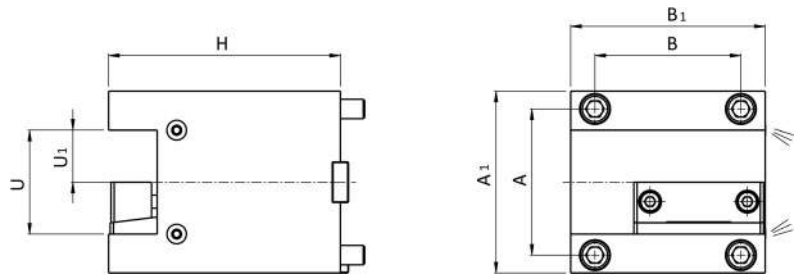

102/BMT75		Codice code - code - Bestell Nr.	U	U1	U2	H	H1	H2	H3	A	B	A1	B1	A2	B2	B3
  EXTERNAL	<b>E10/UD 32 T75X85</b>		64	32		85				90	90	112	181		60,5	60,5
	<b>E10/UD 1.25" T75X85</b>		2.5"	1.25"		85				90	90	112	181		60,5	60,5



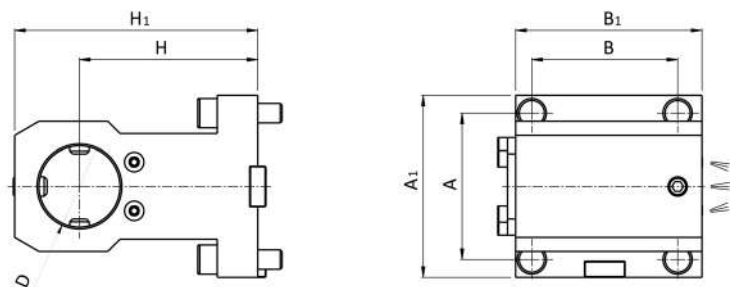

103/BMT75		Codice code - code - Bestell Nr.	U	U1	U2	H	H1	H2	H3	A	B	A1	B1	A2	B2	B3
  EXTERNAL	E10/UA 32 T75X70		64	32		70				90	90	112	120			
	E10/UA 1.25" T75X70		2.5"	1.25"		70				90	90	112	120			



104/BMT75		Codice code - code - Bestell Nr.	d	d1	d2	H	H1	H2	H3	A	B	A1	B1	A2	B2	B3
  INT./EXT.	E10/B 50 T75X60		Ø 50			60	110			90	90	112	115			
	E10/B 60 T75X60		Ø 60			60	110			90	90	112	115			
	E10/B 2" T75X60		Ø 2"			60	110			90	90	112	115			
	E10/B 2.5" T75X60		Ø 2.5"			60	110			90	90	112	115			
	E10/B 50 T75X110		Ø 50			110	150			90	90	112	115			
	E10/B 60 T75X110		Ø 60			110	150			90	90	112	115			
	E10/B 2" T75X110		Ø 2"			110	150			90	90	112	115			
	E10/B 2.5" T75X110		Ø 2.5"			110	150			90	90	112	115			



**La produzione:  
il lavoro**Production:  
work

La produzione viene sviluppata nella moderna struttura a temperatura controllata di Almenno San Salvatore, mentre negli stabilimenti di Brembilla (I-Bergamo) vengono effettuate le lavorazioni di montaggio ed assemblaggio di gruppi completi. La superficie coperta delle strutture è di mq. 15.000, dei quali mq. 1.000 sono adibiti agli uffici amministrativi, commerciali e tecnici. L'attività produttiva si svolge con l'utilizzo di impianti e macchinari CNC costantemente aggiornati alle nuove tecnologie ed in grado di sviluppare le seguenti lavorazioni:

- Asportazione di truciolo
- Elettroerosione
- Tornitura orizzontale e verticale
- Fresatura universale 5 assi
- Fresatura/tornitura
- Lappatura per fori e piani
- Rettifica in tondo interno ed esterno
- Rettifica in tangenziale oltre al montaggio di gruppi e sottogruppi completi.

*The production is developed in the modern, temperature controlled facility in Almenno San Salvatore, with Brembilla factories there are the assembly operations and the assembly of complete groups. The facilities covered area is of 15,000 sqm., 1,000 sqm. of which are used for the administrative commercial and technical offices. The production cycle takes place with the use of CNC fixtures and equipment constantly updated with new technologies and able to develop the following machining:*

- Chip machining
- Electroerosion
- Horizontal and vertical turning
- 5-axis universal milling
- Milling/turning
- Lapping for holes and plane surfaces
- Cylindrical internal and external grinding
- Tangential grinding in addition to the assembly of complete groups and subassemblies.

**Certificazioni:  
uno standard  
qualitativo**Certification:  
a quality  
standard

La tecnologia avanzata svolge un ruolo chiave nell'obiettivo di incrementare il proprio valore, quello dei propri prodotti, dei servizi e della capacità del personale, operando nel rispetto delle norme UNI EN ISO 9001:2008 e ISO 14001:2004. L'alto livello di sensibilità verso il rispetto delle regole di sicurezza e dell'ambiente è presente ed immediatamente percepito in tutte le strutture aziendali.

*Advanced technology plays a key role aiming to increase its value and the products, services and staff capacity value, operating in compliance with UNI EN ISO 9001:2008 and ISO 14001:2004.*

*The high level of sensitivity towards the observance of safety rules and the environment is present and perceived immediately in all facilities.*



UNI EN ISO 9001:2008 - Cert. n° 0141



UNI EN ISO 14001:2004 - Cert. n° 0270A



ALGRA S.p.A. Divisione accessori  
Via Manzoni, 41 24031 Almenno S. Salvatore (BG)  
Tel. +39 035.64.20.51 • Fax +39 035.64.01.28  
algra.accessori@algra.it - www.algra.it