

V75100X VISE OWNER'S MANUAL

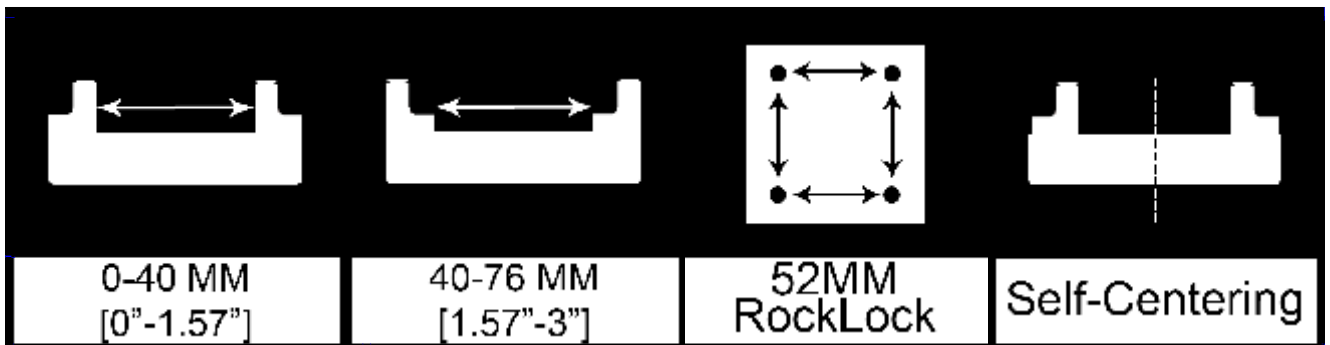
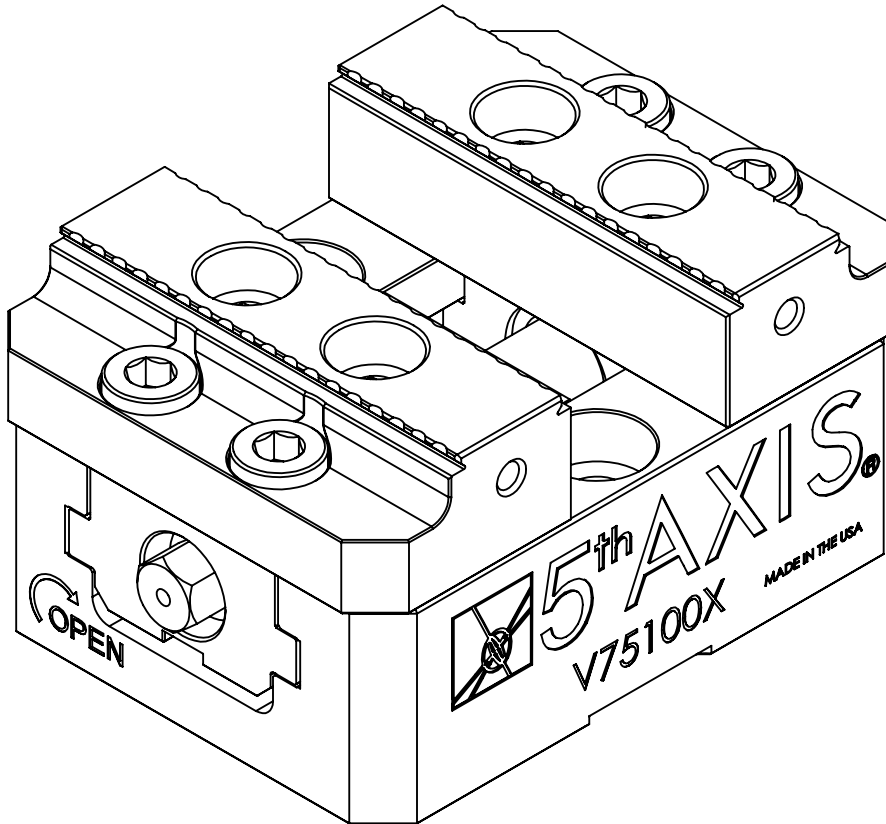

BILL OF MATERIAL

| ITEM NO. | PART NUMBER | DESCRIPTION | QTY |
|----------|-------------|---------------------------|-----|
| 1 | SB3V | SHOULDER BOLT | 2 |
| 2 | LP8 | LOCATING PIN | 2 |
| 3 | M5X10.DP | DOWEL PIN 5x10MM | 2 |
| 4 | V75100X-4RK | LEADSCREW REPLACEMENT KIT | 1 |
| 5 | V75100X-2 | TRUCK | 2 |
| 6 | V75100X-1 | V75100X VISE BODY | 1 |
| 7 | V75100X-5 | MASTER JAWS | 2 |
| 8 | 76232 | SHCS M8x16MM | 8 |
| 9 | TS10 | THUMBSCREW | 1 |
| 10 | LB8008C5-A | ANTI-SIEZE PACKET | 1 |
| 11 | 76252 | BOLT M8x40MM | 2 |

INCLUDED IN BOX



9: THUMBSCREW
P/N:TS10

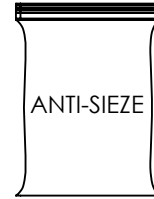

10: ANTI SIEZE
PACKET
P/N: LB8008C5-A

11: MOUNTING BOLT X2
M8x40

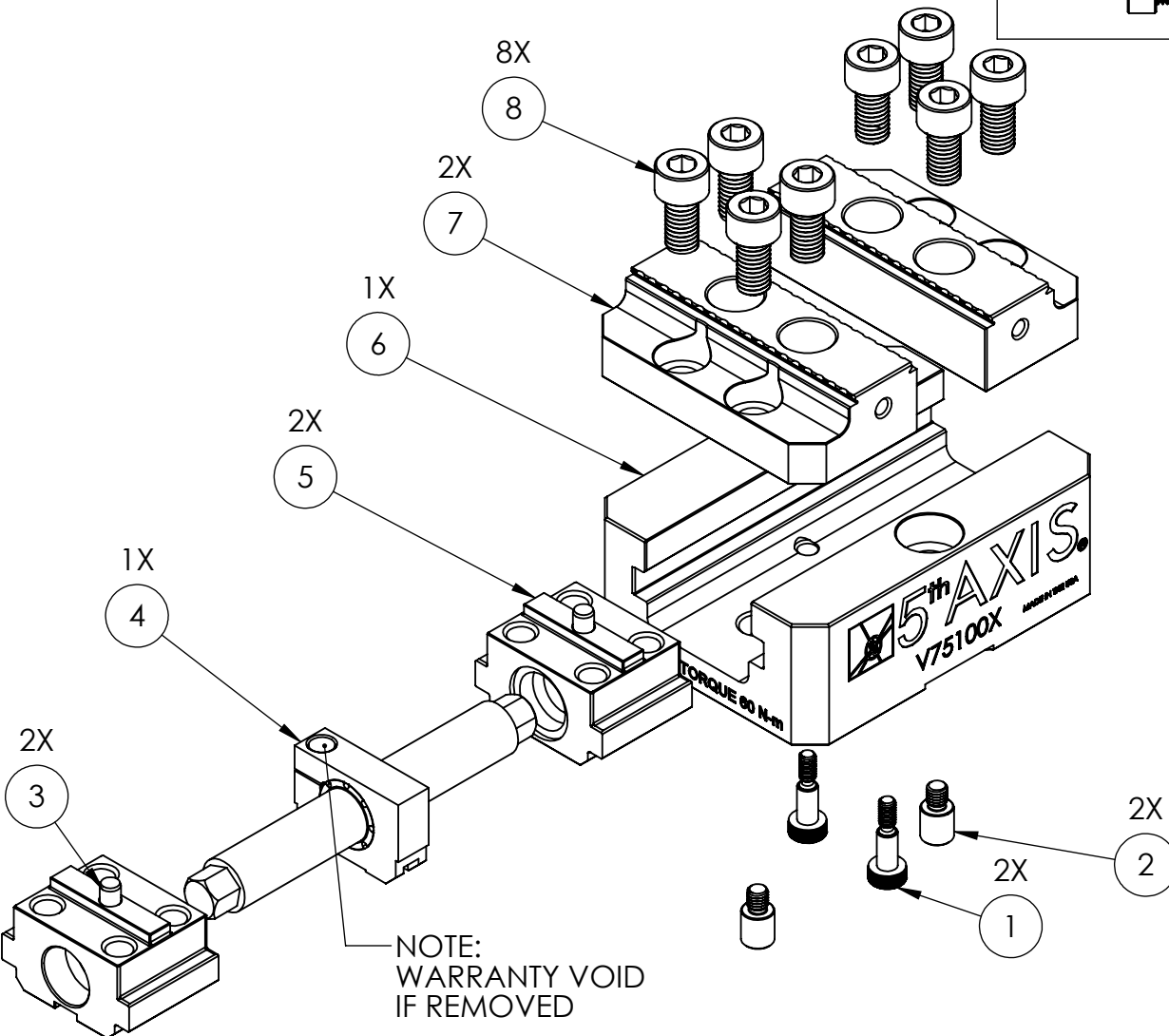

Maintenance and Use

- Clean leadscrew with soft brush
- Use copper based anti-sieze on leadscrew (Loctite P/N: LB8008C5-A)
- Do not let chips build up during use
- Do not torque vise past 60 Nm [45 Ft LBS]
- Do not side load vise (see illustration below)
- Clamping Force at max torque with Master Jaws installed-22.2 kN [5000 lbf]
- Weight: 2.72 Kg [5.16 lbs]

Torque Values

- Jaw Bolts: 27 Nm [20 Ft LBS]-M8x16mm (P/N: 76232)
- Mounting Bolts: 34 Nm [25 Ft LBS]-M8x40mm (P/N: 76252)
- Lead Screw: 60 Nm [45 Ft LBS] Max

Special Notes

- Removing leadscrew assembly is not recommended and will void the warranty
- Failure to follow these instructions will cause self centering accuracy and/or repeatability to fail and may cause damage to the vise
- It is recommended to use only the two outside locating pin holes [LP8] labeled on page 4 as "A & B"

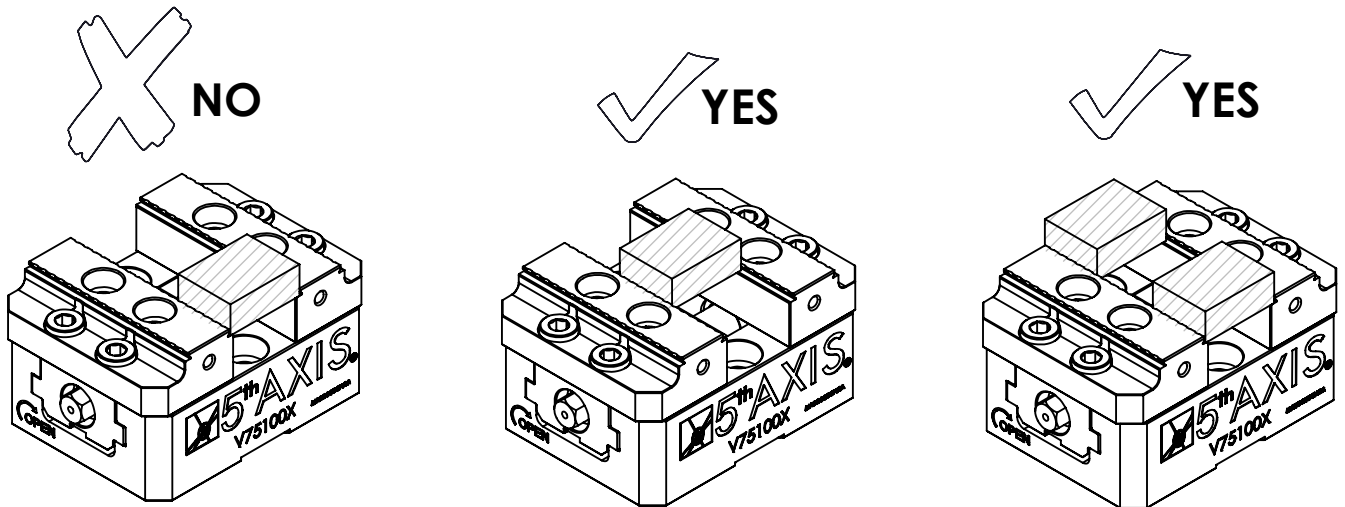

To Machine Profiles into Soft Jaws/Anti-Lift Soft Jaws:

- Insert an appropriately sized shim between the jaws
- Torque to operating torque value
- Machine profile of part
- Remove shim and place the part in vise
- Torque to same value as previous

Following these steps will ensure the highest accuracy and will compensate for any jaw deflection in the vise.

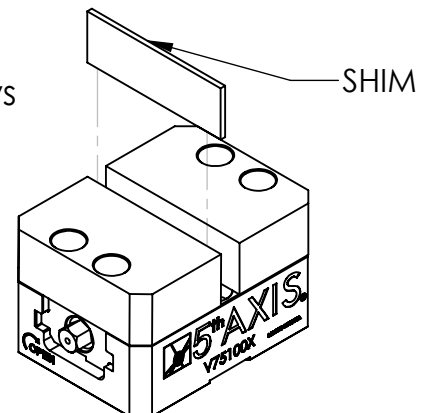

DIMENSIONS

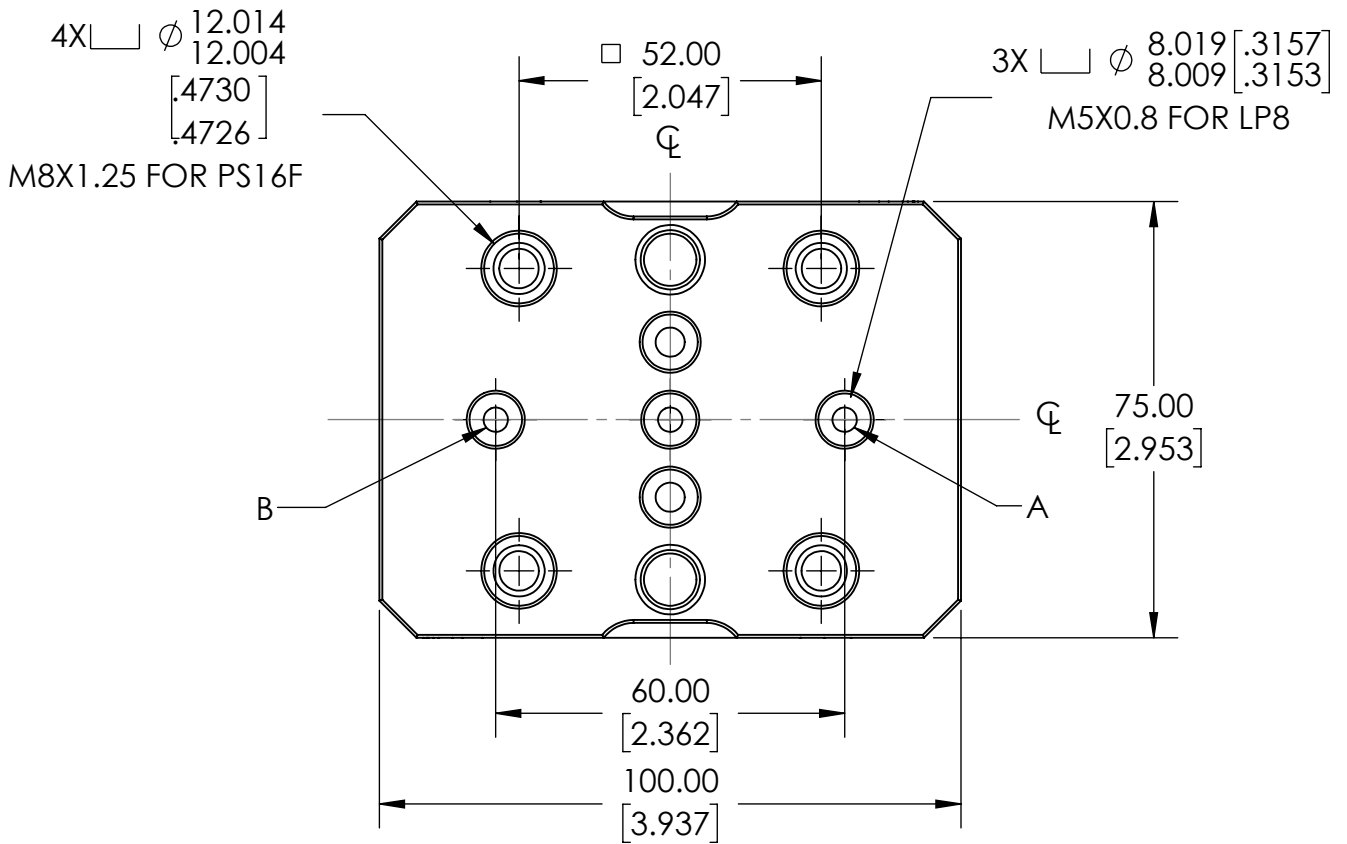
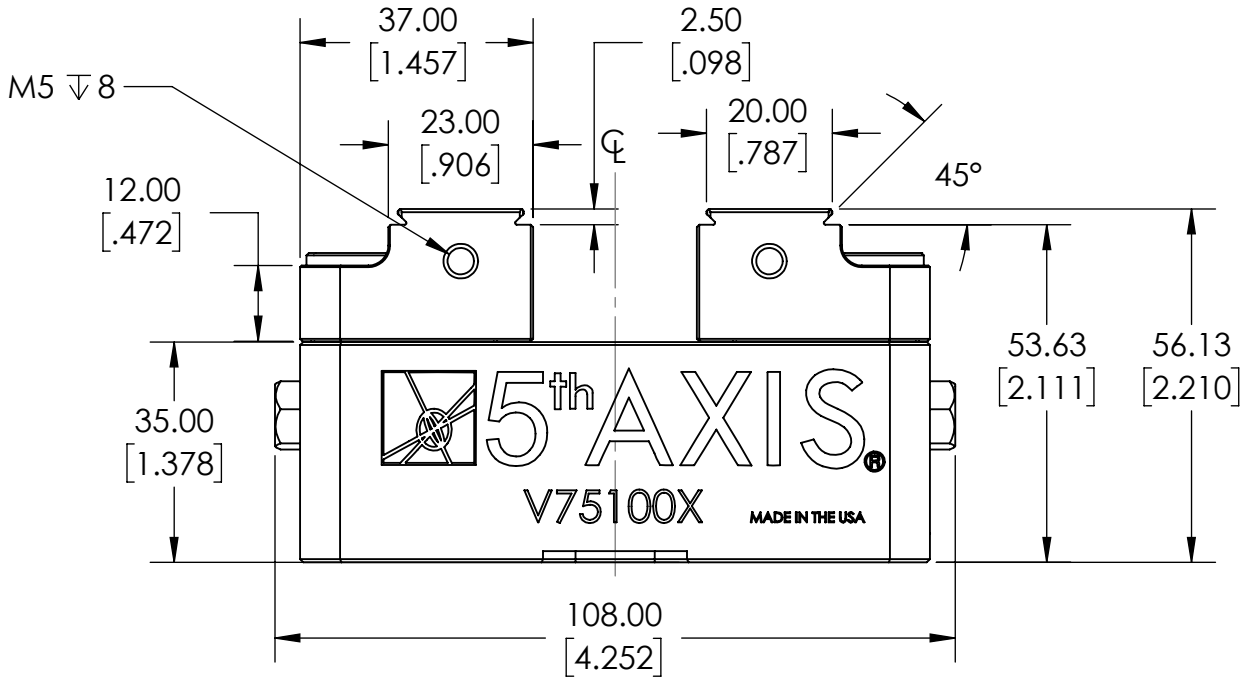

CONFIGURATIONS

Use Serrations For:

- Softer Materials (Aluminum and soft steels)
- Less Aggressive Machining

Use Dovetail for:

- Harder Materials
- Heavier Machining
- Parts Larger than the Vise

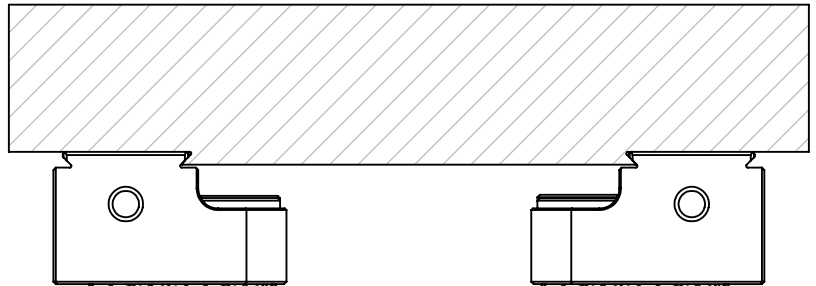
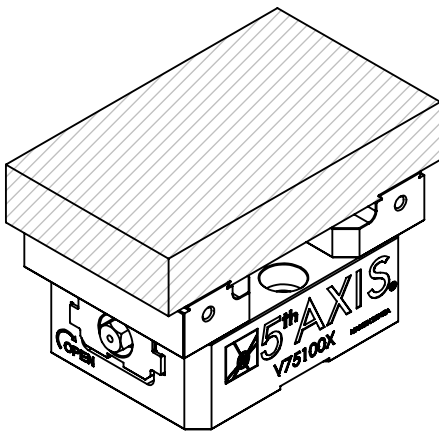
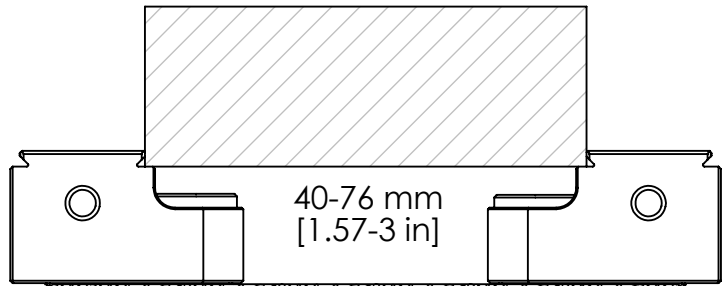
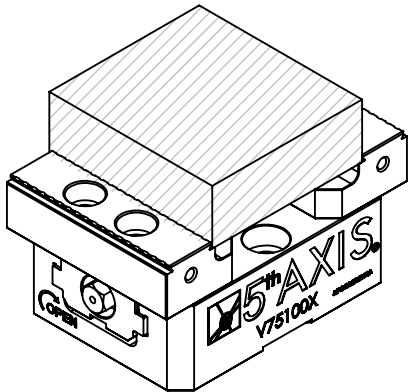
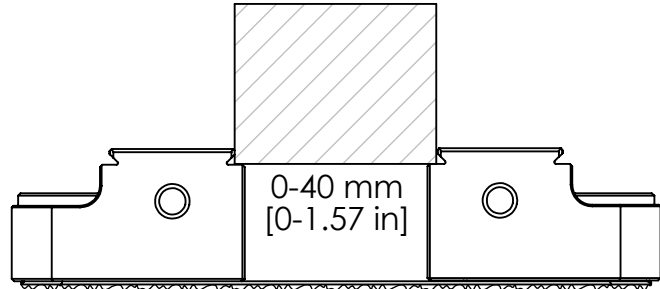
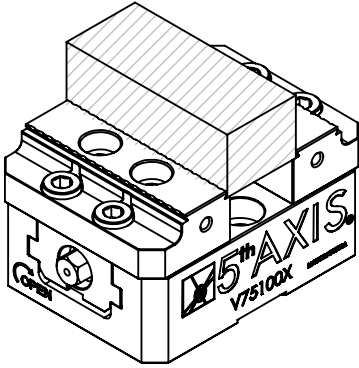

(See next page for dovetail stock prep)

Dovetail Stock Prep

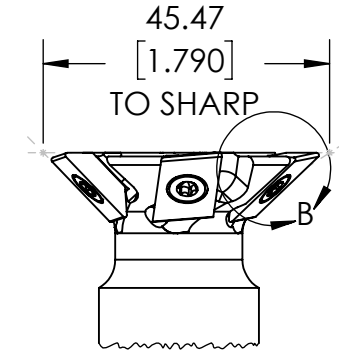
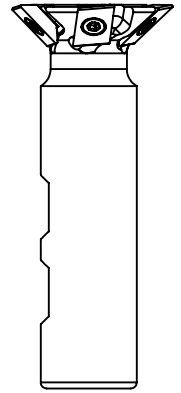

Dovetail Cutter

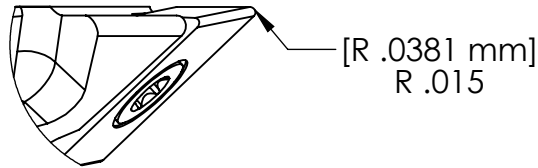

DETAIL B
SCALE 2 : 1

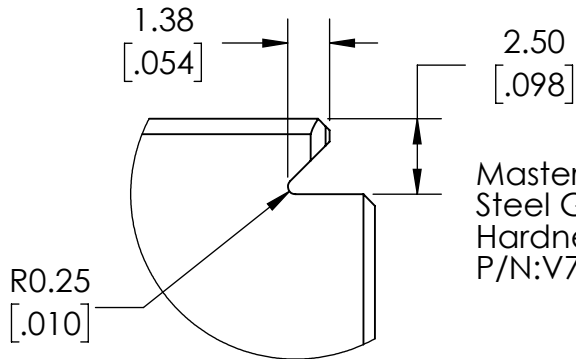
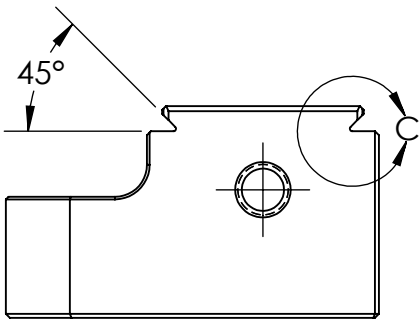

DETAIL C
SCALE 4 : 1

Master Jaws
Steel Grade: 4140 Steel
Hardness: HRC 53-57
P/N:V75100X-5

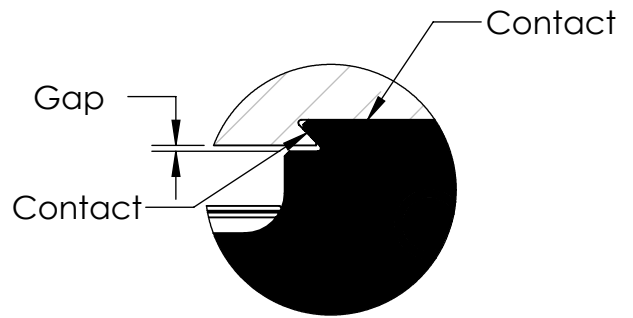
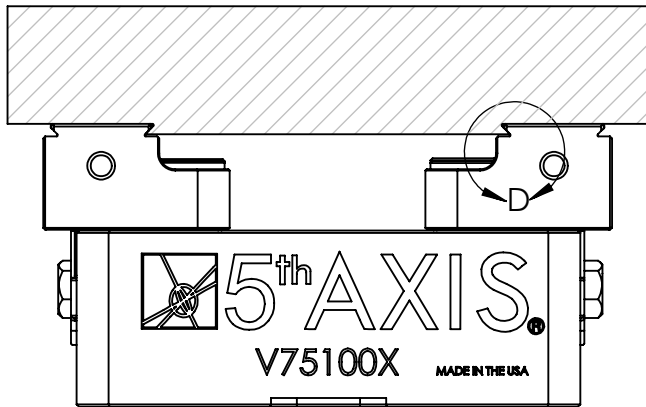

DETAIL D
SCALE 2 : 1.2

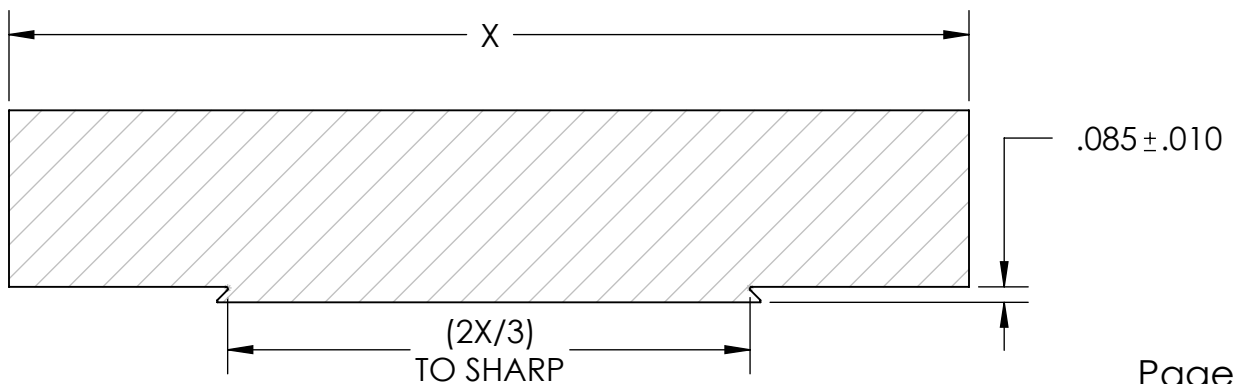

ACCESSORIES

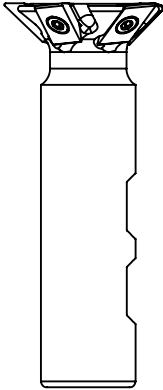

Cutter Details

- Shank Diameter (in) 1" (P/N: DC1750-45)
- Shank Diameter (mm) 25mm (P/N: DC1750-M)
- Insert Part Number: DC1750-B
- 45 Degrees
- Material H13 Tool Steel
- 5 Flute Cutter
- Cutting Diameter: 45.5mm [1.79in]



52mm Pull Studs

P/N: PS16-F

- For 52mm Rocklock
- Hardened S7 Tool Steel
- M8 Threads

Installing Pull Studs

- Secure threaded stud finger tight only
- Grease precision surfaces
- Torque to 10 Ft-lbs via bottom hex head

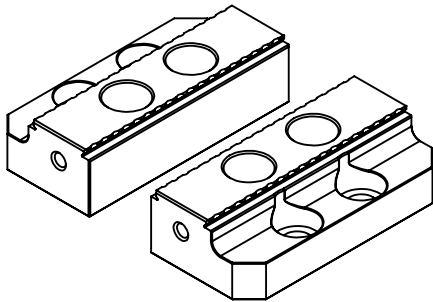

Replacement Master Jaws

P/N: V75100X-5

- P/N: V75100X-5
- 75mm x 37mm x 21mm

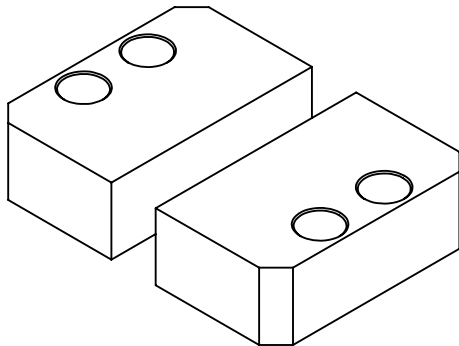

Soft Jaws

VAJ75X- Aluminium

P/N: VAJ75X

- 6061-T6
- Compatible with V75100 and V75100X
- 75mm x 45mm x 25mm

VSJ75X-Steel

P/N: VSJ75X

- 1018 Annealed
- Compatible with V75100 and V75100X
- 75mm x 45mm x 25mm

DOWNLOAD DRAWINGS AT: FIFTHAXIS.COM/DOWNLOADS

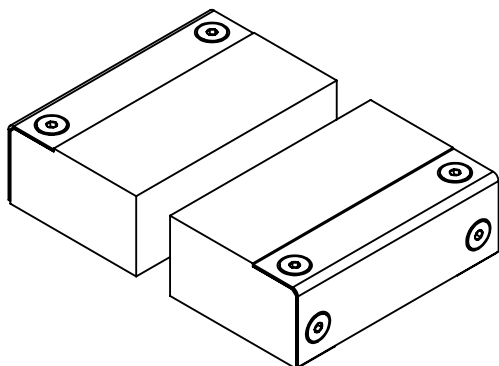

Anti-Lift Soft Jaws

P/N: AL75XA (ALUMINUM), AL75XS (STEEL)

REPLACEMENT JAW P/N: AL75-2A (ALUMINUM), AL75-2S (STEEL)

WHAT IS INCLUDED

- Anti-Lift Cleats
- AL75 Anti-Lift Soft Jaws
- Jaw Covers
- Jaw Cover Hardware

BENEFITS

- High Precision Op 2
- Reduced Jaw Lift <.025mm (<.001 in)
- Patent Pending
- Available in Aluminum and 1018 Steel



V75100X OWNER'S
MANUAL

REV A
APPROVED 5/1/2019

Available for download
at: fifthaxis.com/downloads