

8

7

6

5

4

3

2

1

**MATERIAL:**  
**RL96S-67M: 1018 STEEL BODY**

**1. USE TWO SHOULDER BOLTS TO LOCATE AND CLOCK THE BASE**

# RL96S-67M

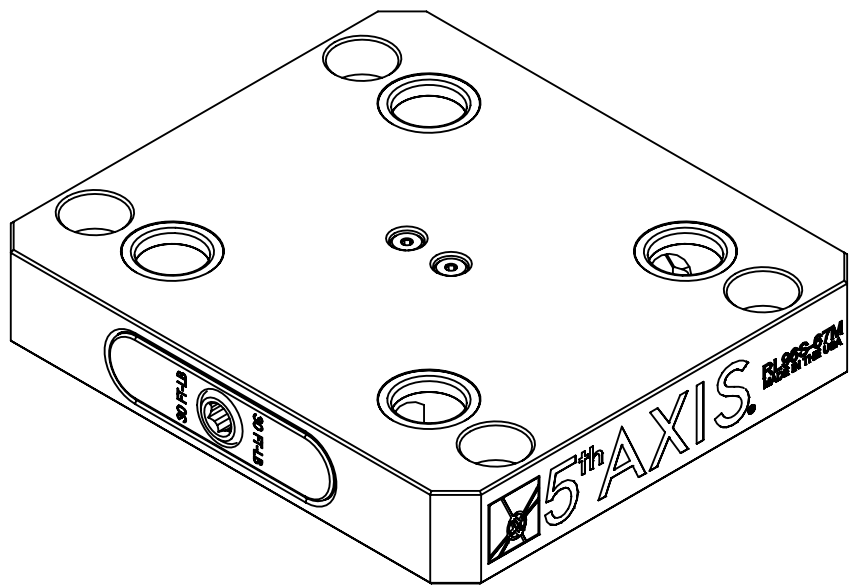

4x M12 AT 100.00MM x 150.00MM GRID

**1. COUNTERBORES DESIGNED TO BE USED WITH SB/SHCS**

4x FITS PS20F

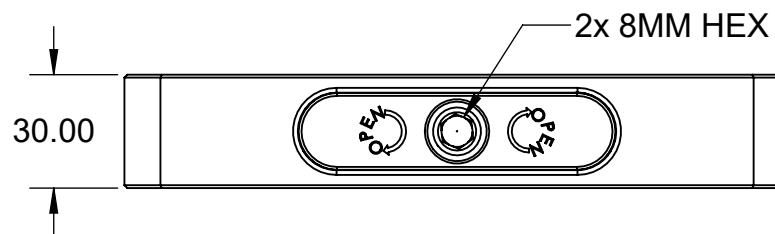
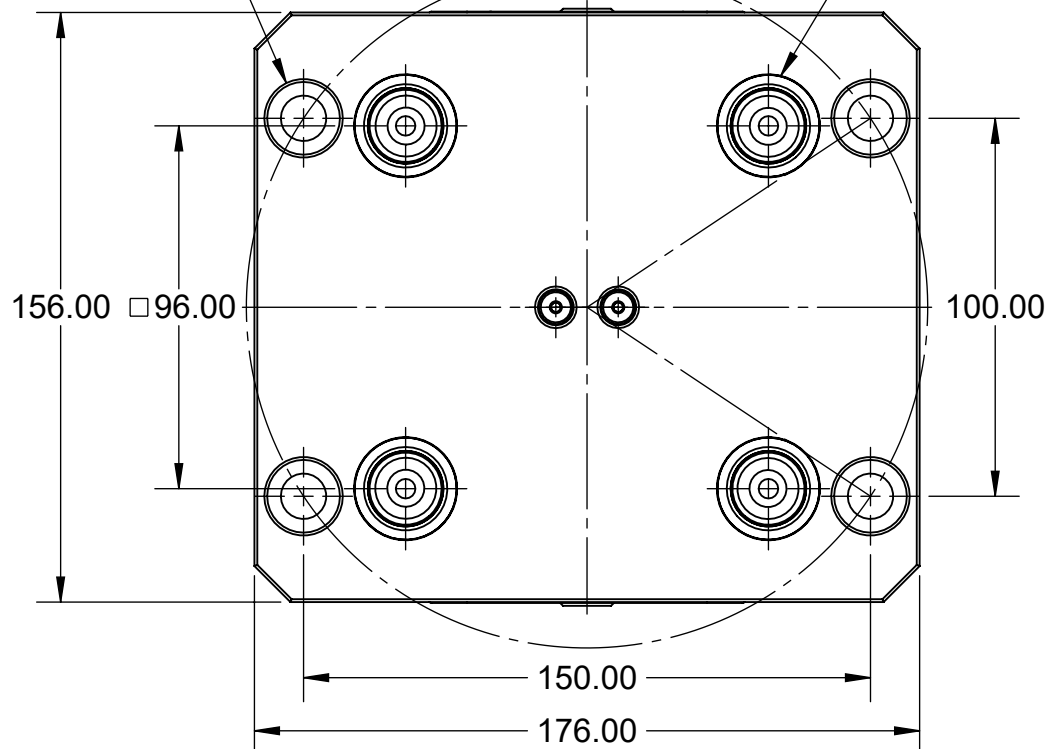

$\phi 8.026^{+0.013}_{0.000} \downarrow 3.68$

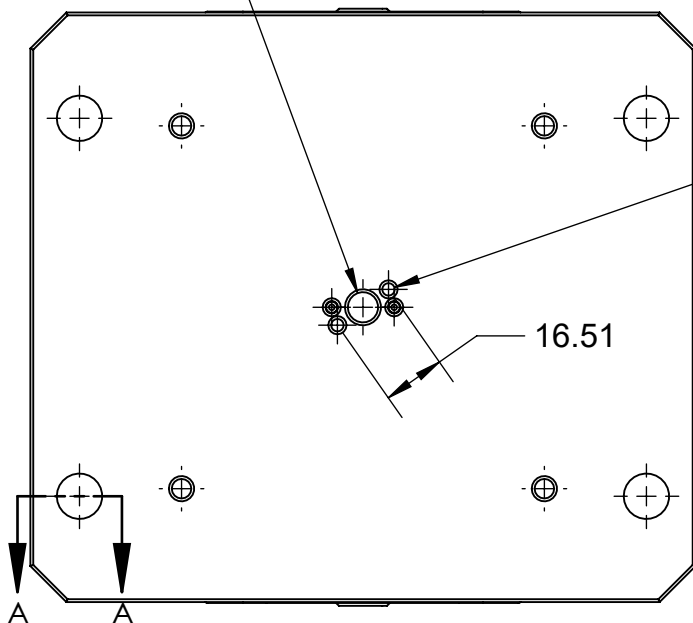

2x  $\phi 3.30 \downarrow 5.08$   
M4X0.7  $\downarrow 3.81$

$\phi 19.25$  CBORE FOR M12 SB/SHCS

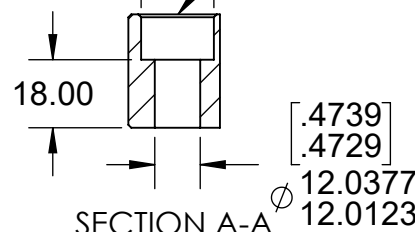

<b>MILLIMETER</b> <small>DRAWN IN ACCORDANCE WITH ASME Y14.5-2009</small>  WWW.5THAXIS.COM  7140 ENGINEER ROAD SAN DIEGO, CA 92111  P (858) 505-0432 F (858) 505-9344	<b>TOLERANCES</b> <small>UNLESS OTHERWISE SPECIFIED</small> x ± 0.1    .xx ± 0.01 .x ± 0.05    .xxx ± 0.005 ANGULAR ± 0.5° THIRD ANGLE PROJECTION			
		<b>DESCRIPTION</b> ROCKLOCK™ 96MM LOW-PROFILE BASE		
		<b>SIZE</b> <b>B</b>	<b>PART NO.</b> <b>RL96S-67M</b>	<b>REV</b> <b>A</b>
DO NOT SCALE DRAWING		SCALE 1:2	WEIGHT:	SHEET 1 OF 2

8

7

6

5

4

3

2

1

D

D

C

C

B

B

A

A

8

7

6

5

4

3

2

1

**MATERIAL:**  
**RL96S-67M: 1018 STEEL BODY**

# RL96S-67M

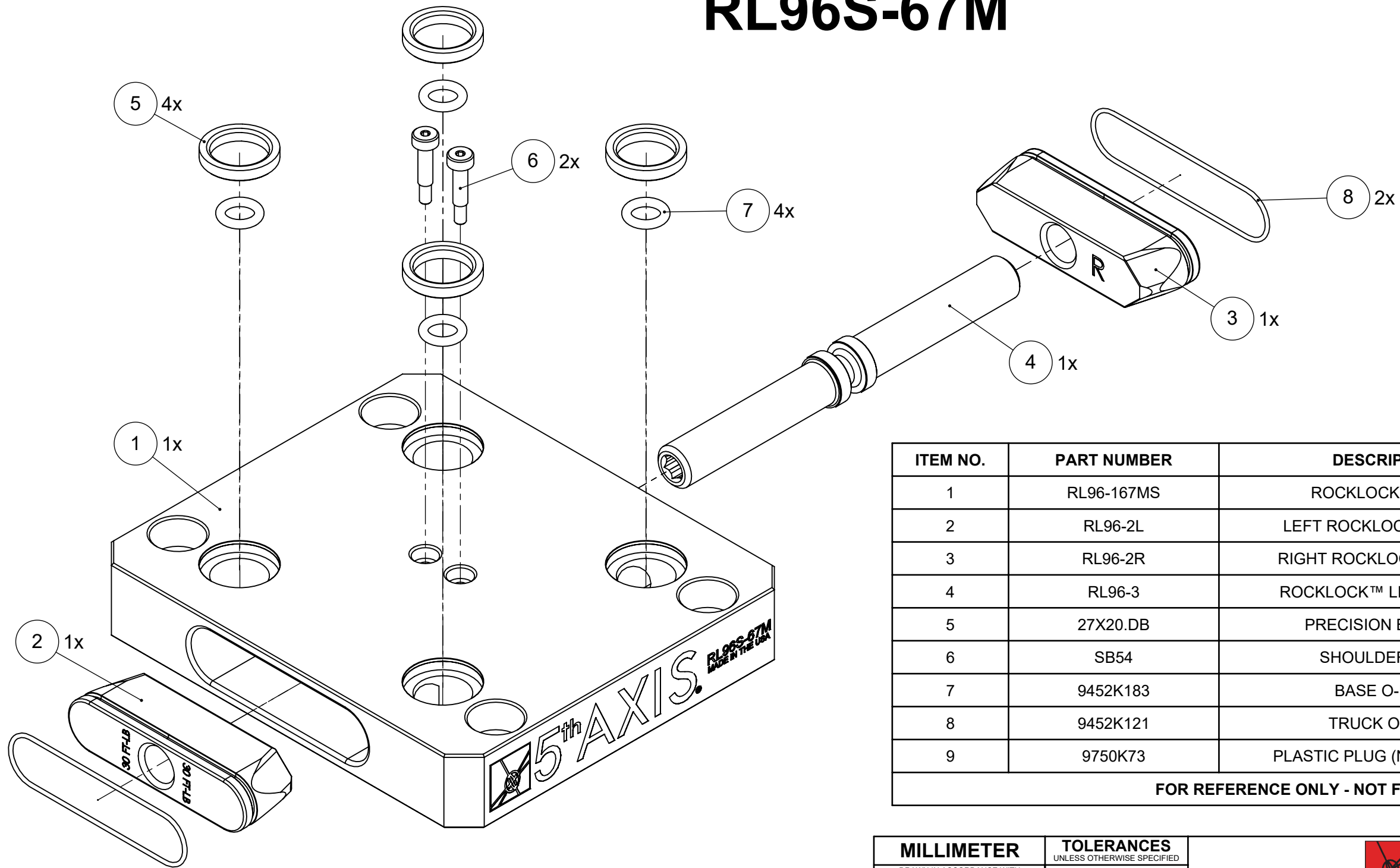

ITEM NO.	PART NUMBER	DESCRIPTION	QTY.
1	RL96-167MS	ROCKLOCK™ BASE	1
2	RL96-2L	LEFT ROCKLOCK™ TRUCK	1
3	RL96-2R	RIGHT ROCKLOCK™ TRUCK	1
4	RL96-3	ROCKLOCK™ LEAD SCREW	1
5	27X20.DB	PRECISION BUSHING	4
6	SB54	SHOULDER BOLT	2
7	9452K183	BASE O-RING	4
8	9452K121	TRUCK O-RING	2
9	9750K73	PLASTIC PLUG (NOT SHOWN)	4

**FOR REFERENCE ONLY - NOT FOR RESALE**

<b>MILLIMETER</b> <small>DRAWN IN ACCORDANCE WITH ASME Y14.5-2009</small>  <small>WWW.5THAXIS.COM</small>  <small>7140 ENGINEER ROAD SAN DIEGO, CA 92111</small>  <small>P (858) 505-0432 F (858) 505-9344</small>	<b>TOLERANCES</b> <small>UNLESS OTHERWISE SPECIFIED</small> <small>x ± 0.1    .xx ± 0.01</small> <small>.x ± 0.05    .xxx ± 0.005</small> <small>ANGULAR ± 0.5°</small> <small>THIRD ANGLE PROJECTION</small>			
		<b>DESCRIPTION</b> <b>ROCKLOCK™ 96MM LOW-PROFILE BASE</b>		
		<b>SIZE</b> <b>B</b>	<b>PART NO.</b> <b>RL96S-67M</b>	<b>REV</b> <b>A</b>
<small>DO NOT SCALE DRAWING</small>		<small>SCALE 2:3</small>	<small>WEIGHT:</small>	<small>SHEET 2 OF 2</small>

8

7

6

5

4

3

2

1