

testa ad angolo - angle head

# TAO26.P



caratteristiche/features

$\phi$  26 M20 1590 N

1-1 3000

peso/weight

24 kg

rotazione/rotation

input output

prestazioni/performance

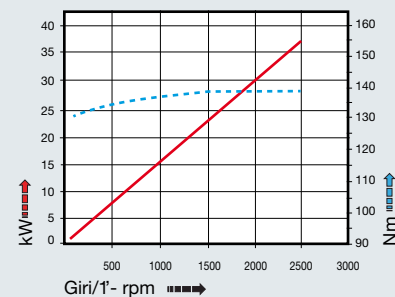

tipi mandrino disponibili / available spindle types

- 2** Albero portafresa  
Milling shaft  
Ø22-Ø27-Ø32
- 3** Weldon  
Whistle-Notch  
Ø16-Ø20
- 4** DIN69893-HSK  
HSK63

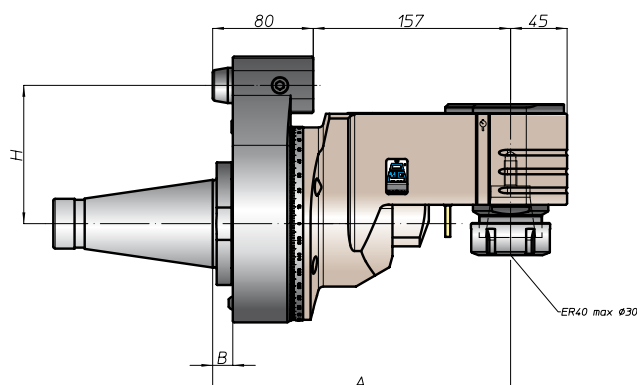
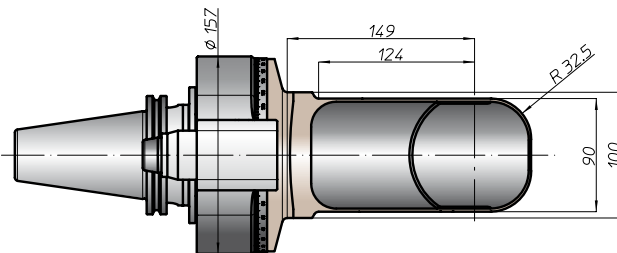
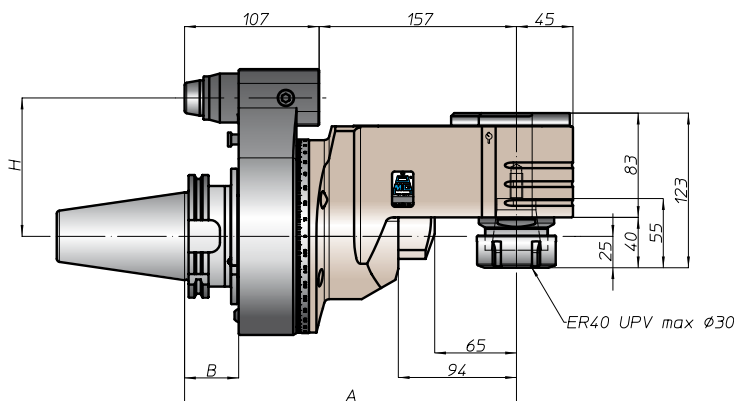
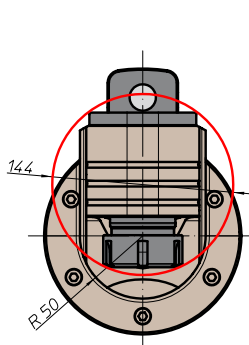

| CONO SHANK      | size | H   |    |          |          |
|-----------------|------|-----|----|----------|----------|
|                 |      | A   | B  | standard | optional |
| DIN69871 *      | -    | -   | -  | -        | -        |
| ANSI B5.50 *    | 50   | 270 | 35 | 110      | -        |
| BT              | 50   | -   | -  | 110      | -        |
| HSK             | 100  | 279 | 46 | 110      | -        |
| CAPTO           | C8   | 274 | -  | 110      | -        |
| KM              | 100  | 270 | -  | 110      | -        |
| DIN2080         | 50   | 243 | 16 | 110      | -        |
| ANSI B5.18 NMTB | 50   | 243 | 16 | 110      | -        |

\* Option: Dual Contact

