

TAO13.P

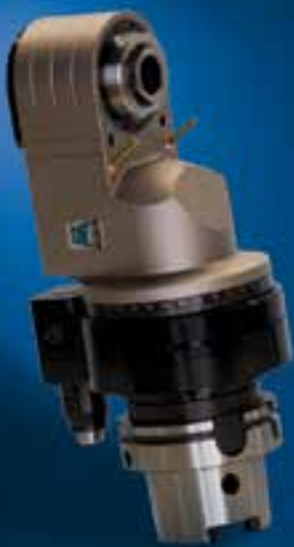

caratteristiche/features

ø 13 M10 570 N

 1-1 4500

peso/weight

7,5 kg 10,5 kg

rotazione/rotation

→
 input output

prestazioni/performance

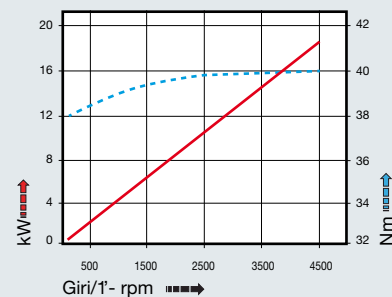

tipi mandrino disponibili / available spindle types

- 2** Albero portafresa
Milling shaft
Ø16
- 3** Weldon
Whistle-Notch
Ø12
- 4** DIN69893-HSK
HSK32

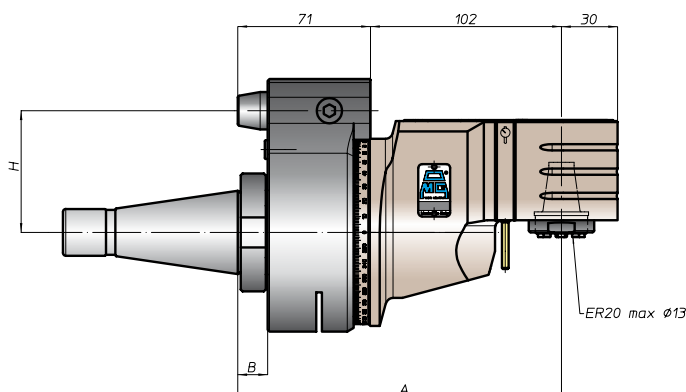
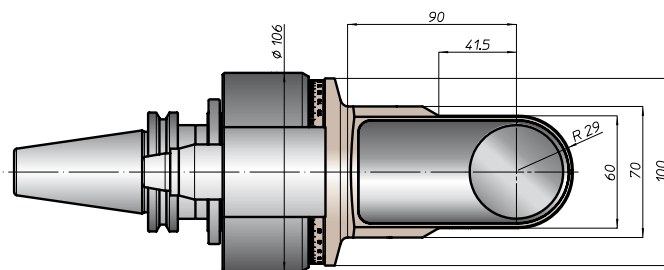
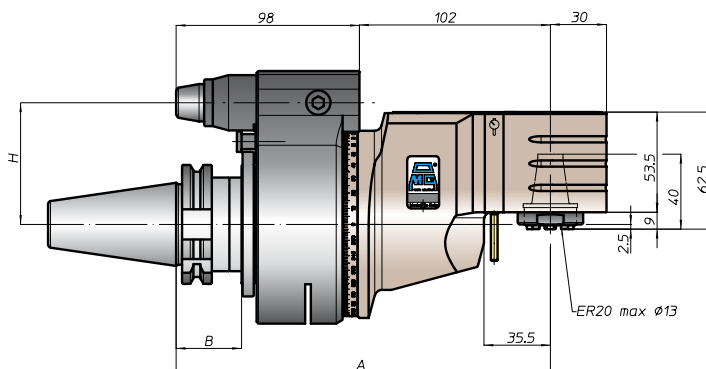
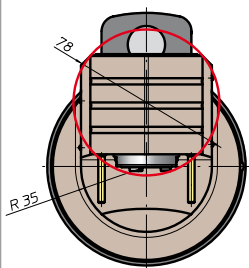

CONO SHANK	size	H			
		A	B	standard	optional
* DIN69871	-			65	-
	40	200	35	80	110
	45			80	110
50	80			110	
* CAT ANSIB5.50	40			65	-
	50			80	110
* BT	40			65	
	50	208	45	80	110
HSK DIN69893	63		44	65	
	80	209		80	110
	100		46	80	110
CAPTO ISO28623	C5			65	
	C6	204	39	80	110
	C8			80	110
KM	63			65	
	80	200		80	110
	100		80	110	
DIN2080	-	170	13	65	-
	40			80	110
ANSIB5.18 NMTB	-	176	16	80	110
	50			80	110
ANSIB5.18 NMTB	40	173	13	65	-
	50	176	16	80	110

* Option: Dual Contact

