

testa ad angolo - angle head

TAR04.P



caratteristiche/features



peso/weight

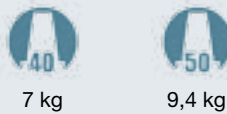

rotazione/rotation



prestazioni/performance

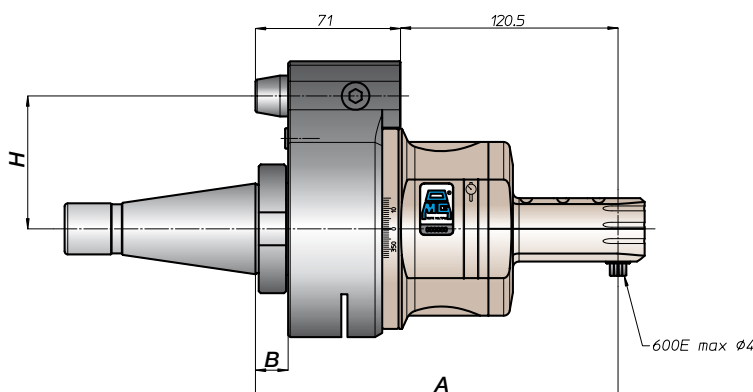
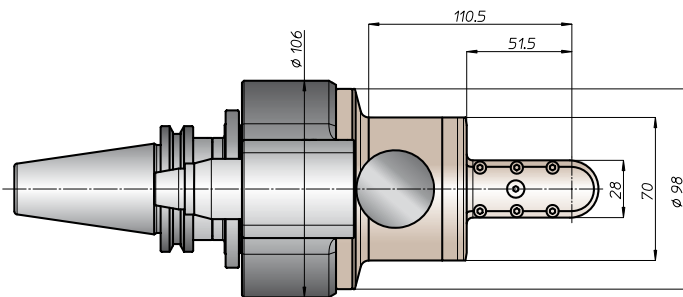
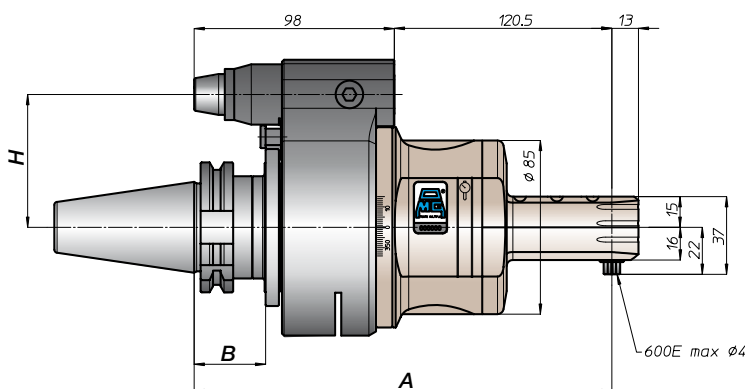
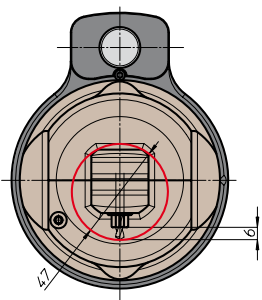
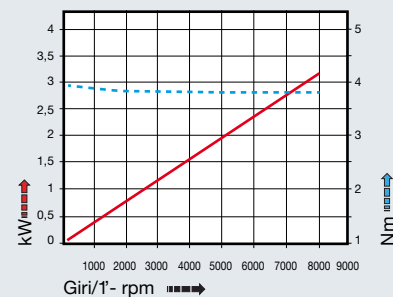

CONO SHANK	size	H			
		A	B	standard	optional
DIN9871 *	30	218,5	35	65	-
	40			80	110
	45			80	110
ANSIB5.50 *	40	226,5	45	65	-
	50			80	110
BT *	40	226,5	45	65	-
	50			80	110
HSK	63	227,5	46	44	65
	80			80	110
	100			80	110
CAPTO	C5	222,5	39	65	-
	C6			80	110
	C8			80	110
KM	63	218,5	13	65	-
	80			80	110
	100			80	110
DIN2080	-	188,5	13	65	-
	40			80	110
	-			191,5	16
ANSIB5.18	40	188,5	13	65	-
	50			80	110

* Option: Dual Contact

