

# TA26.P



caratteristiche/features

$\varnothing 26$    M20   3020 N  
 1-1   2500

peso/weight

22 kg

rotazione/rotation

input   output

prestazioni/performances

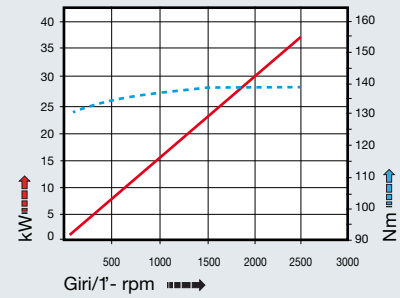

tipi mandrino disponibili / available spindle types

- 2** Albero portafresa  
Milling shaft  
 $\varnothing 16$ - $\varnothing 27$ - $\varnothing 32$
- 3** Weldon  
Whistle-Notch  
 $\varnothing 32$
- 4** DIN69893-HSK  
HSK63
- 5** COROMANT  
CAPTO®  
C4
- 6** ABS  
Licenza KOMET®  
ABS50

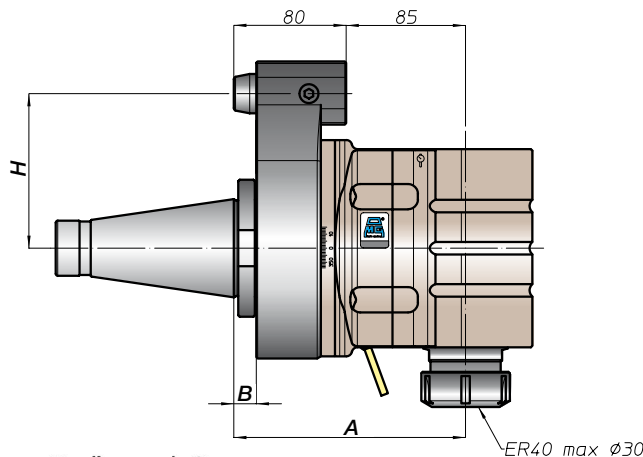
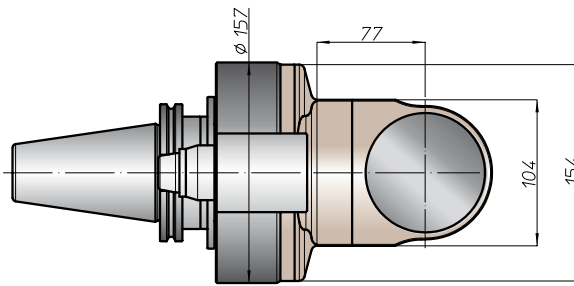
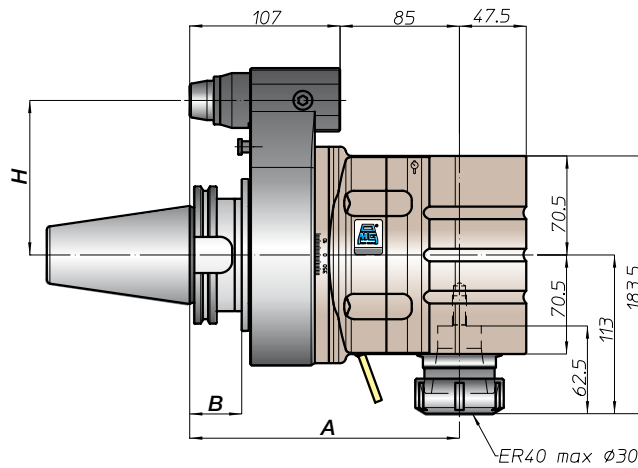
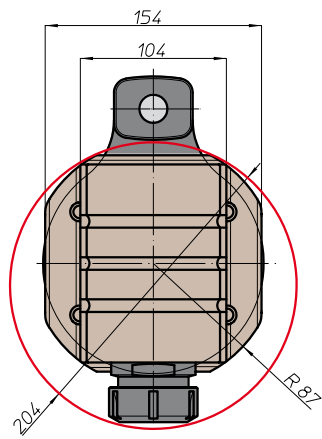

CONO SHANK	size	H			
		A	B	standard	optional
DIN69871 *	-	-	-	-	-
DIN69871 *	45	-	-	110	-
	50	192	35	-	-
ANSIB5.50 *	-	-	-	-	-
ANSIB5.50 *	50	-	-	110	-
BT *	-	-	-	-	-
BT *	50	200	45	110	-
HSK	-	-	-	-	-
DIN69893	80	-	-	110	-
	100	201	46	-	-
CAPTO	-	-	-	-	-
ISO28623	-	196	-	110	-
	C8	-	-	-	-
KM	-	-	-	-	-
KM	-	192	-	110	-
	100	-	-	-	-
DIN2080	-	-	-	-	-
DIN2080	-	165	16	110	-
	50	-	-	-	-
NMTB	-	-	-	-	-
ANSIB5.18	50	165	16	110	-

\* Option: Dual Contact

