

# TA26.40



caratteristiche/features



peso/weight



22 kg

rotazione/rotation



input



output

prestazioni/performance

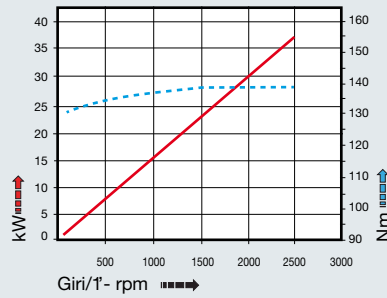

CONO SHANK	size	A	B	H	
				standard	optional
DIN69871 *	-	192	35	-	-
	45			110	-
ANSIB5.50 *	50	192	35	110	-
	CAT			-	-
BT *	50	200	45	110	-
	HSK			-	-
DIN69893	80	201	46	110	-
	100			-	-
CAPTO	-	196	-	-	-
	ISO26623			-	110
KM	-	192	-	-	-
	100			110	-
DIN2080	-	165	16	110	-
	50			-	-
ANSIB5.18	-	165	16	-	-
	NMTB			50	110

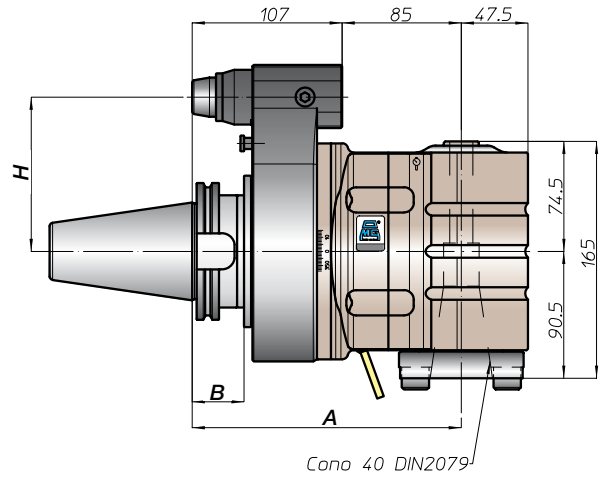
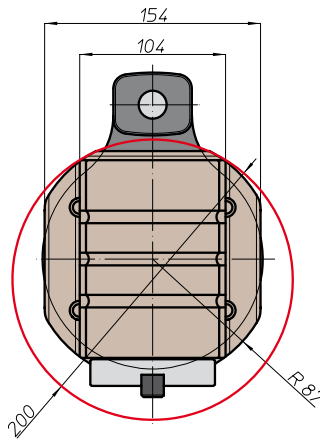

Cono 40 DIN2079

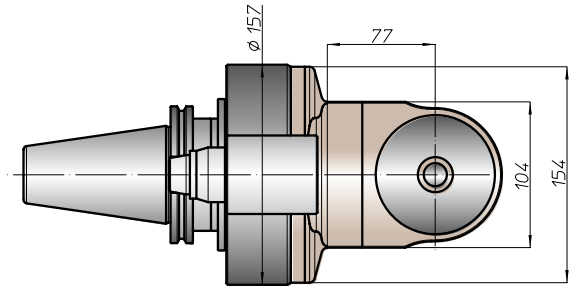

Nota:

- nel mandrino DIN2079 si possono utilizzare coni DIN2080-40, DIN69871-A40, MAS403-BT40

Note:

- on the spindle DIN2079 you can use shank DIN2080-40, DIN69871-A40, MAS403-BT40

